

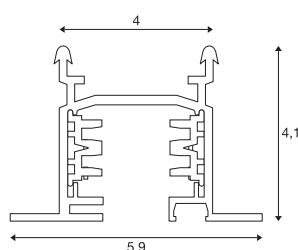

## EUTRAC 3-PHASE RECESSED TRACK

high-voltage track, white, 3 m

Aluminium carrier track of the EUTRAC 240V 3-circuit recessed track system. The surface-mounted version of this system is available in several lengths. The special design makes it possible for ceiling panels to be put onto the rail itself. For more detailed information about the maximum load, please refer to the instructions in the manual. Alternatively, there is a surface-mounted version available too. Please note that the white tone will be changing from RAL 9010 to RAL 9016 (traffic white) on 1st April 2018. More information can be found under Product Information in the Service" / Downloads area.



### TECHNICAL DATA

Item no.	1001532
IP Code	IP 20
Assembly	Recessed
Assembly details	Ceiling
Nominal voltage	220-240V ~50/60Hz V
Safety class	I
Color	white
Length	300 cm
Width	5.9 cm
Height	4.1 cm
Net weight	3.328 kg
Gross weight	4.931 kg
BIG WHITE Page	439