

RADIO PLUG RP200 USER INSTRUCTION

Save energy!

iJaz Programmable Wireless Control System
for BEHA Panel Heaters



EL-nr:
5449901 White
5449902 Black

230 Volt - 400 Volt.

The iJaz system is simple in design and can be installed without professional assistance.

The iJaz system offers control of four settings:

1. Normal room temperature
2. Lower room temperature by 5 °C
3. Security against sub zero temperature.
Min. 5 °C room temperature
4. Heater off



EL-nr: 5449903

iJaz Accessories:

SP 16 Wireless on/off switch for standard wall outlet

The SP 16 switches lights, hot water tank, coffee maker etc. automatically on and off at set times.

BEHA ELEKTRO AS
NO-3940 PORSGRUNN, NORWAY
post@beha.no - www.beha.no



4 RP200 Functions

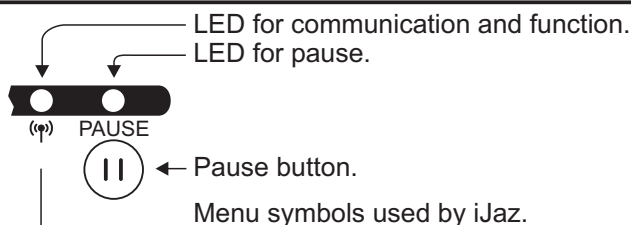

	Function activated
Green light (continuous)	No temperature reduction. The set heater temperature applies.
Green light (blinking)	Room temperature is lowered 5 °C from set temperature.
Green light (rapid blinking)	Frost safeguard. Minimum 5 °C in the room.
Orange light (continuous) (Red and green together)	Heater off. Can only be used with "Absent" programme.

Pause function

The green LED will be lit when the RP 200 pause function is activated (not by iJaz central control)

Pause is activated by pressing the "Pause" button. If "Pause" is activated it will automatically be reset to normal at the next temperature lowering period.

Cold Draft function

If a window is opened and the inside temperature drops in the area where a heater is installed the Cold Draft function will automatically be activated. The Cold Draft function makes the heater switch automatically between set temperature (for 10 sec.) and frost safeguard (for 30 sec.). The function is active for a maximum of 15 minutes each time.

1 Installation of RP200

Remove the protection cover on the thermostat and switch off the heater. Then remove the white plastic dummy blank.

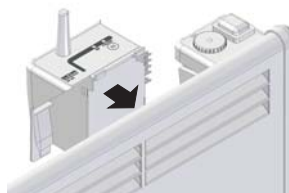
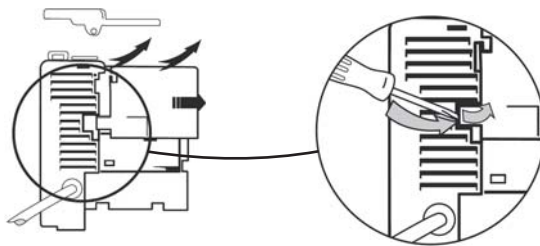

Insert the Radio Plug RP 200 into the slits in the plug pocket.

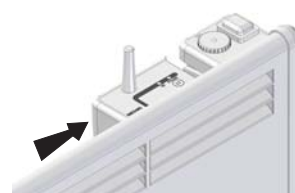

Then move the RP 200 towards the thermostat. Make sure the contact pins match the female side in the thermostat.

A "click" will confirm correct installation.

The heater may be switched on.

2 Connection RP200 to iJaz

The following procedure must be used when connecting a RP200 radio plug to the iJaz central unit:

To establish contact between the iJaz central unit and a radio plug RP 200 the iJaz central unit has to transmit a connection signal to the RP 200. Set the iJaz to the chosen zone on the display as follows:

1. Press "Menu", and then press "Zones". Choose or create a zone, then press "Connect". iJaz will now transmit a signal that will be received by the RP 200 in question. The RP 200 can be connected to a heating zone only.
2. Hold the "Pause" button on the RP 200 for 3 to 5 sec. The RP 200 will acknowledge the connection with 3 blinks on the green communication LED. If the red communication LED blinks 3 times, the connection failed. Make sure iJaz is transmitting a heating zone signal.

If the "Pause" button is pressed for 3 to 5 sec. without receiving a connection signal from iJaz the LED will blink red three times.

3 Power failure / communication failure

If a power failure occurs for a limited period of time the RP 200 will start automatically when the power comes back on. The same situation occurs when a heater has been switched off by the on/off switch on the heater. When this is done the RP 200 cannot identify what condition to choose due to the fact that iJaz does not transmit continuously. The RP 200 will show a steady green light until iJaz sends a new command which is done every 5 minutes. Only then the new command will be valid.

If a test signal is transmitted from iJaz the "Pause" light (green LED) will blink.