

LEDVANCE Connected Sensor

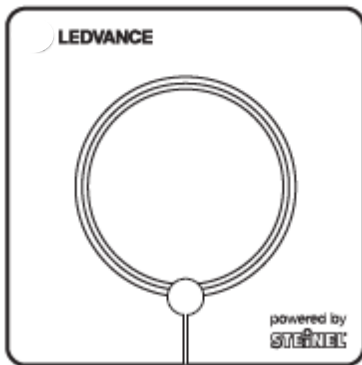

Innovative sensor for **SubstiTUBE T8 Advanced Ultra Output Connected tube 1.2m & 1.5m**

Brand name: **LEDVANCE** Powered by **Steinel**

- Zigbee communication
- No need WIFI / Apps/ Smartphone for installation
- Ideal for warehouses, parking lots, corridors, stairways

Technical operating data

Product	Diameter	Height	Voltage [V] / Frequency [Hz] Input current [mA]	Power [W]	IP
Connected Sensor CR (Circular)			200 - 240 V		
Connected Sensor RT (Rectangle)	6,6cm	9,5cm	50 Hz 10mA	1	54
Connected Sensor HB (High Bay)					

All Data are related to the entire sensor. Due to the special conditions of the manufacturing processes of sensor, the typical data of technical parameters can only reflect statistical figures and do not necessarily correspond to the actual parameters of each single product which could differ from the typical data.

- | | |
|--------------------------------------------------------------|-----------------------------------------------------------------------------------------------------------------------------|
| ➤ Installation: On-top ceiling mounting | ➤ Up to 50,000 h lifetime |
| ➤ Ambient temperature: -20... 50°C | ➤ Daylight and Presence detection |
| ➤ Zigbee communication wireless | ➤ CE, VDE certification in progress |
| ➤ Fixed dimming 15% / 100%. Stepless dimming is not possible | ➤ To have connected system OSRAM SubstiTUBE T8 Adv UO Connected and Ledvance sensor have to paired and operated as a system |
| ➤ Lamp off feature possible (optional) | |
| ➤ Daylight and presence detection support lighting the tube. | |

Sensor size

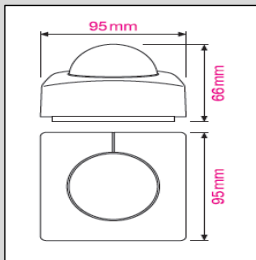

Base Module (inside sensor)

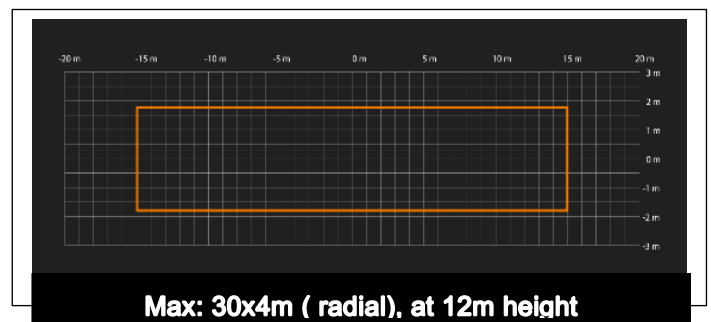
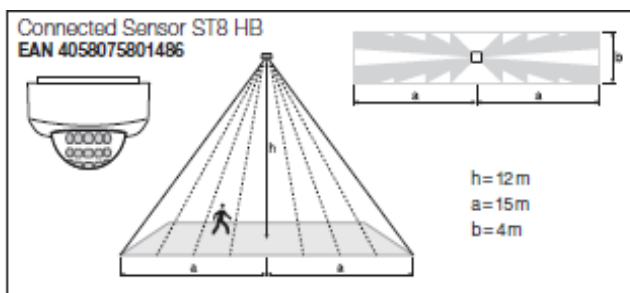
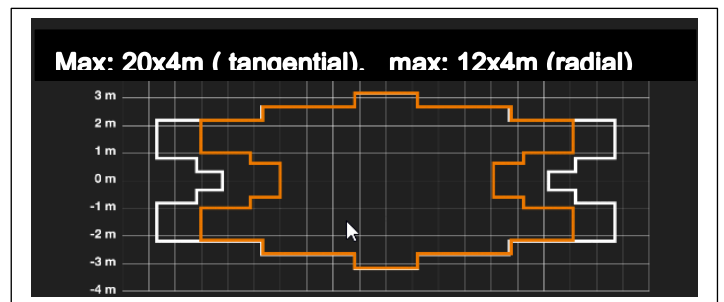
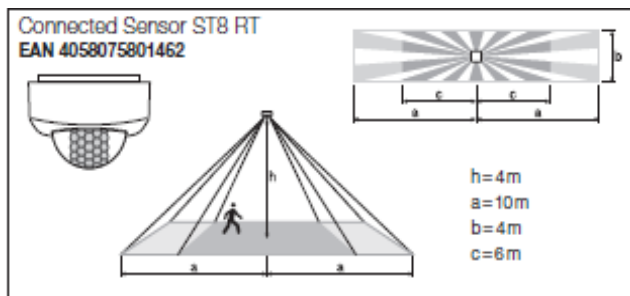
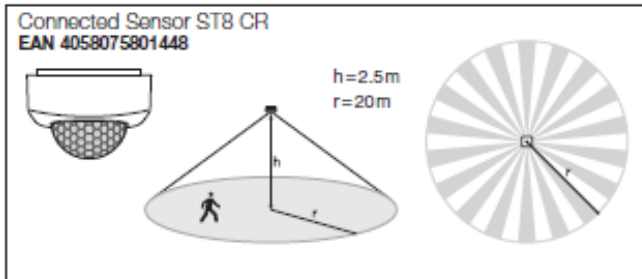
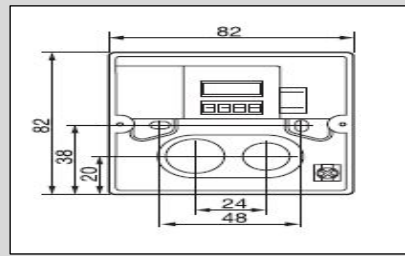

OSRAM connected tube and sensor installation guideline

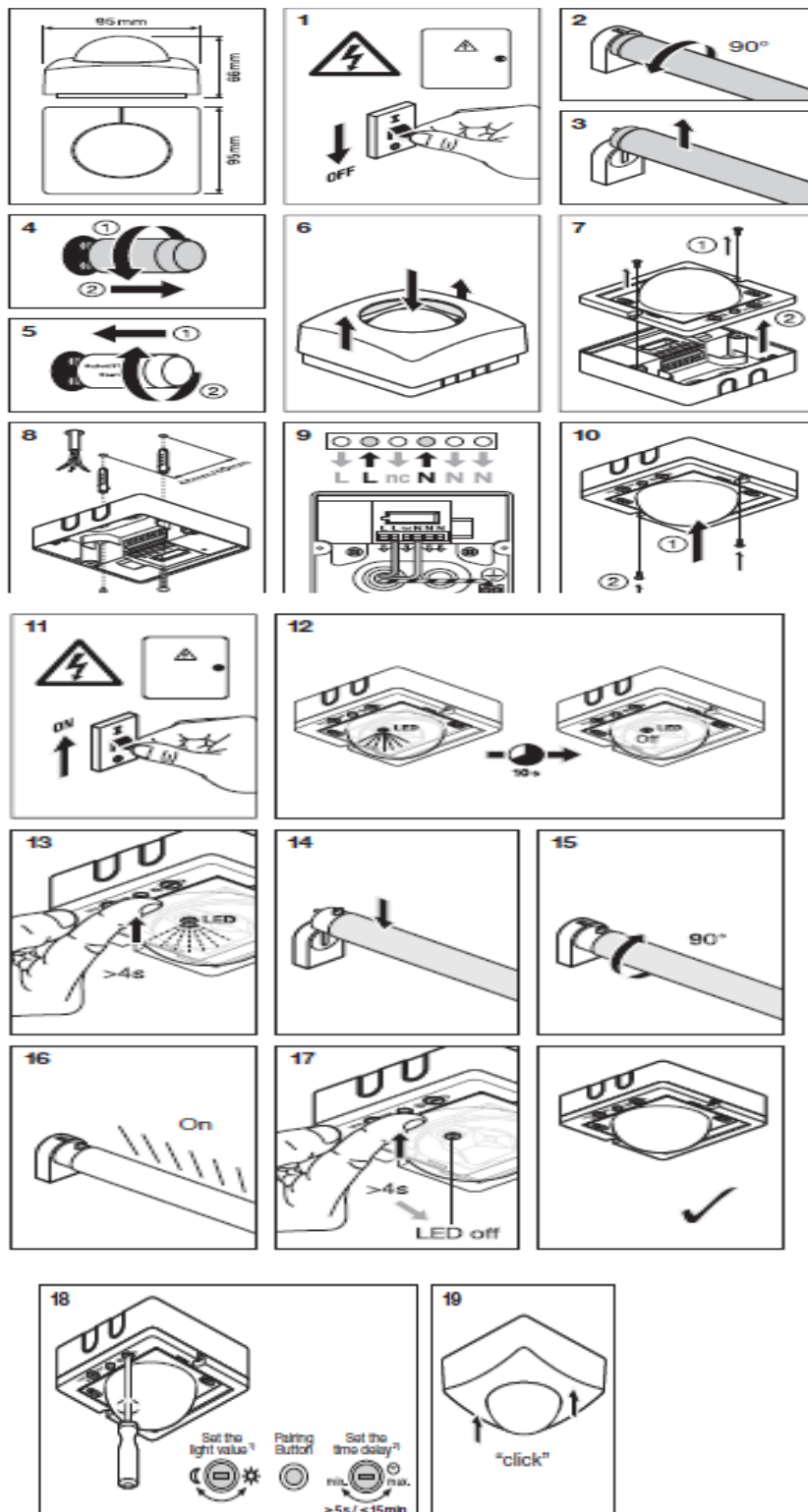

12. Green LED will appear for >10seconds and disappear

13. pairing tube and sensor. Press and hold > 4sec

16. tube will blink one time which means it is starting to pair with sensor

17. tube will dim down to 20% level of tube.

IMPORTANT

How dimming works

Condition: tube and sensor should be paired first

Sensor Passive Infra-red

If people enters the detection zone tube will dim up 100%. When people leave the detection zone tube will return to 20% level based on time delay setting 5sec-15min

Pairing button function

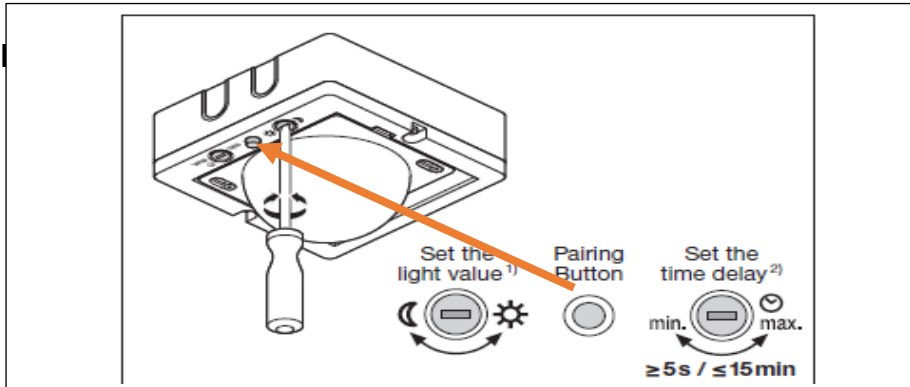

Pairing button functions	Action	Impact
a) Pairing tube and sensor	Pressing pairing button for 4sec	Green LED start blinking
b) Pairing completion	Leave pairing mode by pressing pairing button again for 4sec. (or wait 50minutes)	Green LED will turn off
c) Test function	Press 2times shortly	Paired tubes will start blinking constantly
	Press 2times shortly	Paired tubes will stop blinking
d) Lamp off	Press 4times shortly	Lamp off function will activate in 15min. (if no presence detected) optional
a) How to unpair tube and sensor	Press 10 times shortly	Set back to factory mode

Reset button on the tube function

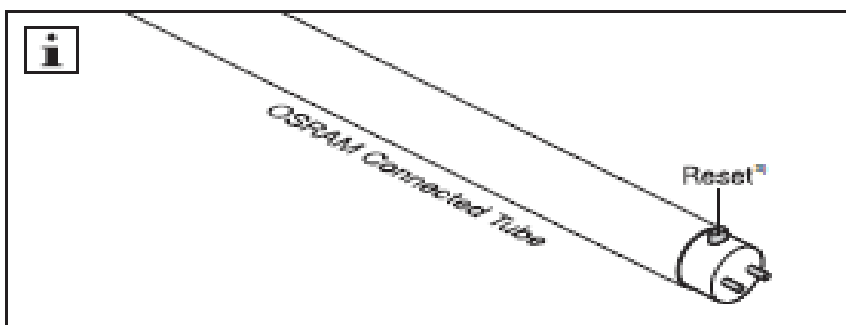

Please do not push **Reset button** of tube during installation

- This function is to leave from the paired network. > 4sec long press
- This button should be used only exit from group network (unpairing)

Ordering guide

Product name	EAN10*	S-Unit**
Connected Sensor ST8 CR	4058075801448	
Connected Sensor ST8 RT	4058075801462	27pcs
Connected Sensor ST8 HB	4058075801486	

* EAN: Ordering number per single module

** S-Unit: Lamps per shipping unit

Sales and Technical Support

Further Information

➤ Please visit www.ledvance.com/substitute-connected (TBC availability)

You can access

1. Installation video
2. User manual
3. FAQ
4. Product information