

Master Uni Install 5W, 2700K

Technical data

Hole diameter:	Ø75 mm
Height:	63 mm
Front size:	Ø87 mm or 87 x 87 mm
Voltage:	220-240VAC 50 Hz
System effect:	Max. 7.5W LED
Socket:	GU10
Light source:	5W LED, 2700 Kelvin
Light intensity:	430 Lumen
Colour rendering:	CRI>80
Beam angle:	38°
Dimmable:	Yes
Tilt angle:	30°
IP-class:	IP44
Insulation class:	Class II
Material:	Plastic, aluminium
Possibility of through wiring:	Yes (3G1.5)
Max. dimmer last:	23 pcs. Uni Install 5W (slave) @ Ta 30° C

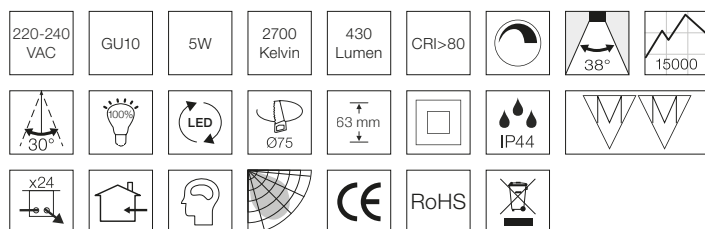

Product information

- Approved for installation directly in the insulation and flammable materials
- Low mounting depth
- With built-in dimmer and memory function
- Adjustable min. setting for dimming
- Max. load 120W @ Ta 30° C
- Quick and easy mounting
- Mounting with screws or adjustable springs
- Screwless terminal block in the connector box
- Possibility of mounting with cable or 16 mm flex tube
- Adjustable springs for ceiling thickness up to 44 mm
- Adjustable screws for ceiling thickness up to 35 mm
- Designed and developed in Denmark

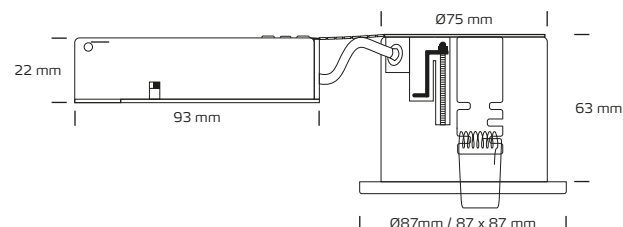
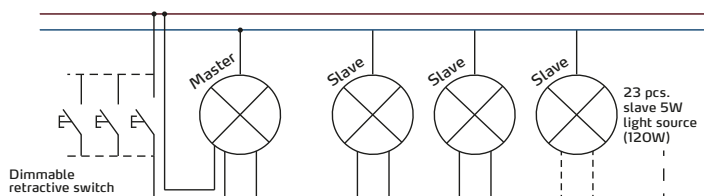

*The drawing is not drawn to scale

This luminaire is compatible with bulbs of the energy classes:

The luminaire is sold with a bulb of the energy class: **A+**

Nordtronic LED Downlight

874/2012

NB: Always use cables of a type approved for permanent installation according to the current legislation. If the cables are in contact with the lamp cover, use cables with an operating temperature of at least 70° C.

Item no.	EAN no.	Colour	Front design
12421	5704629124219	Matt white	Round
12422	5704629124226	Brushed aluminium	Round
12423	5704629124233	Matt white	Square
12424	5704629124240	Brushed aluminium	Square
12427	5704629124271	Chrome	Round
12428	5704629124288	White	Round
12429	5704629124295	White	Square
12430	5704629124301	Matt black	Round