

Master Uni Install 5W, 3000K

Technical data

Hole diameter:	Ø75 mm
Height:	63 mm
Front size:	Ø87 mm or 87 x 87 mm
Voltage:	220-240VAC 50 Hz
System effect:	Max. 7.5W LED
Socket:	GU10
Light source:	5W LED, 3000 Kelvin
Light intensity:	450 Lumen
Colour rendering:	CRI>80
Beam angle:	38°
Dimmable:	Yes
Tilt angle:	30°
IP-class:	IP44
Insulation class:	Class II
Material:	Plastic, aluminium
Possibility of through wiring:	Yes (3G1.5)
Max. dimmer last:	23 pcs. Uni Install 5W (slave) @ Ta 30° C

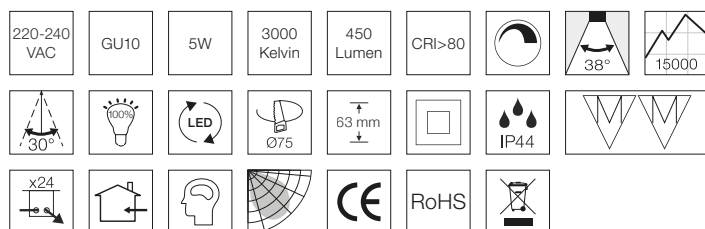

Product information

- Approved for installation directly in the insulation and flammable materials
- Low mounting depth
- With built-in dimmer and memory function
- Adjustable min. setting for dimming
- Max. load 120W @ Ta 30° C
- Quick and easy mounting
- Mounting with screws or adjustable springs
- Screwless terminal block in the connector box
- Possibility of mounting with cable or 16 mm flex tube
- Adjustable springs for ceiling thickness up to 44 mm
- Adjustable screws for ceiling thickness up to 35 mm
- Designed and developed in Denmark

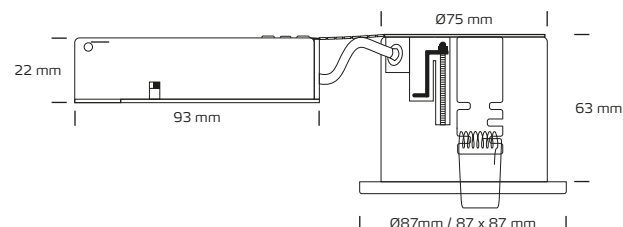
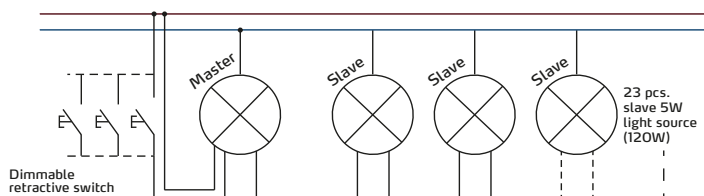

*The drawing is not drawn to scale

This luminaire is compatible with bulbs of the energy classes:

The luminaire is sold with a bulb of the energy class: **A+**

Nordtronic LED Downlight

874/2012

NB: Always use cables of a type approved for permanent installation according to the current legislation. If the cables are in contact with the lamp cover, use cables with an operating temperature of at least 70° C.

Item no.	EAN no.	Colour	Front design
12431	5704629124318	Matt white	Round
12432	5704629124325	Brushed aluminium	Round
12433	5704629124332	Matt white	Square
12434	5704629124349	Brushed aluminium	Square
12437	5704629124370	Chrome	Round
12438	5704629124387	White	Round
12439	5704629124394	White	Square
12440	5704629124400	Matt black	Round