

# SC-TSE1228-160-XX-24V



Available colors



## Features

- White color version adopt 2835 high brightness LED, CRI 80 and CRI 90 both available;
- Mini size 12mm\*8mm with high flexibility, Minimum bending radius can be 50MM;
- Dot-free illumination and high uniformity;
- High quality silicon material, extrusion process makes IP67 ;
- Special window-design makes cutting convenient and easy;
- Providing accesories for cutting and installation.

## Technical parameters

Model	Color	CCT Range	Luminous Flux (lm/M)	LED Type	PCB Width (mm)	Max.Length (M)	Min.Length (mm)	DC Voltage (V)	LED Qty. (PCS/M)	Rated Watt (W/M)	CRI	IP
SC-TSE1228-160-XX-24V	WW	2800K-3200K	877	2835	8	5	50	DC24	160	9.6	80	67
	NW	3800K-4500K	880									
	W	6000K-6500K	863									

\*Note: There will be CCT dewation for white color after the silicon extusion, below is the table for your reference.

Part number	Color	CCT for LEDS(Real tesed data)	CCT for IP67(real tesed data)
SC-TSE1228-160-WW-24V	WW	2951K	2768K
SC-TSE1228-160-NW-24V	NW	4062K	3373K
SC-TSE1228-160-W-24V	W	6674K	5789K

## Dimensions (unit: mm/inch)

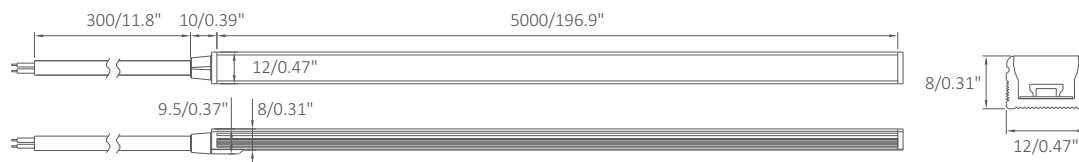

## Accessories

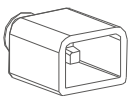
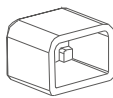
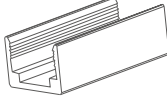
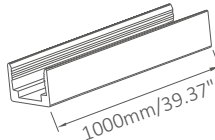
Name	End cap with hole	End cap without hole	Mounting Clip	Mounting Channel
Picture				
Quantity	2pcs per reel	2pcs per reel	20pcs per reel	optional

## Installation diagram

- Cut along the cutting line with scissors, as figure 1;

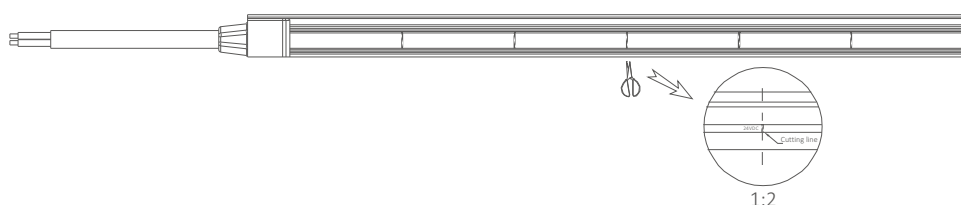



2. Fill the plug with glue and plug the light strip into the plug. The installation is completed., as figure 2

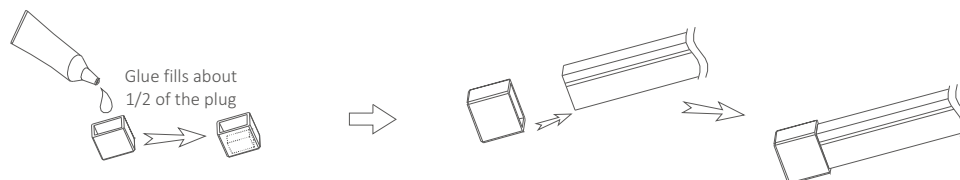

3. Cut the glue on the back of the PCB to expose the solder pad., as figure 3

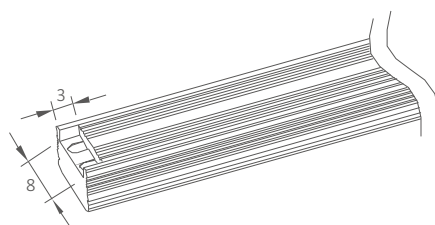

4. Weld the wire to the strip pad with ferro-iron, as figure 4

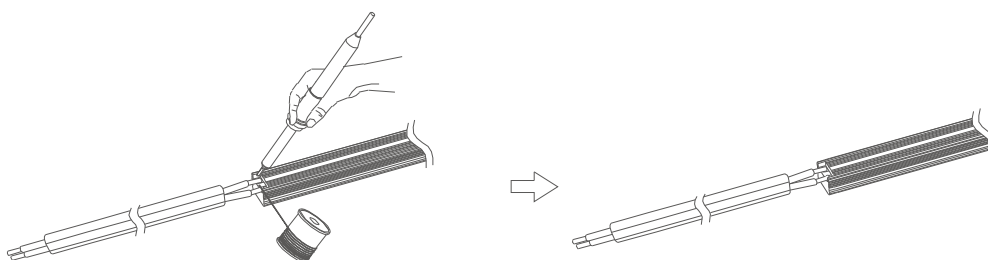

5. Put the plug on the line and repeat the gluing steps as shown in Figure 2. Then plug the lamp strip into the plug and complete the installation, as figure 5.

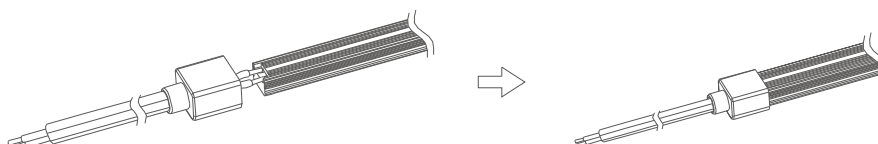



## Installation Precautions

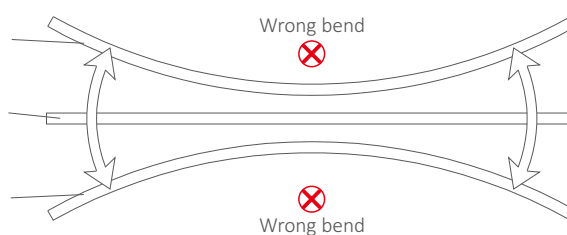
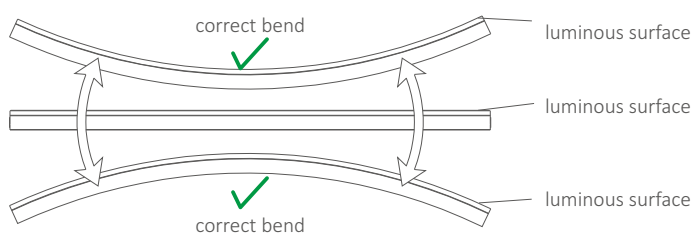
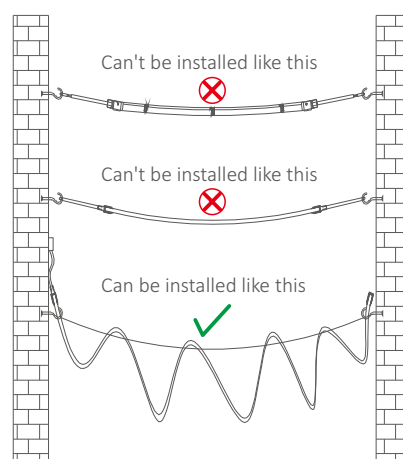
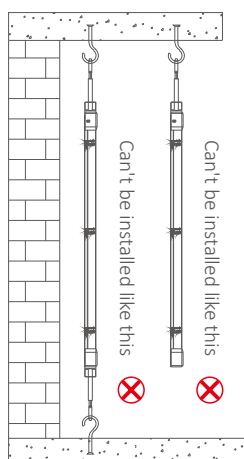
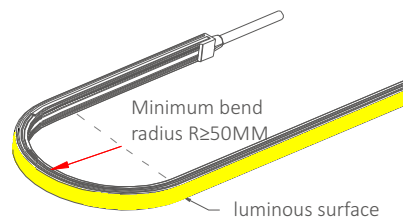
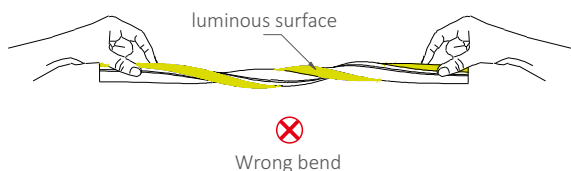

## Packaging information

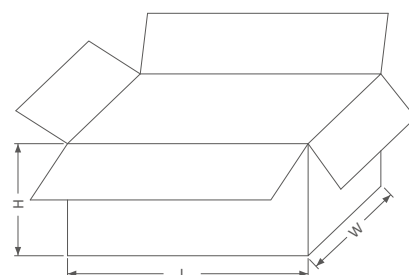
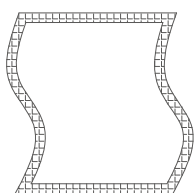
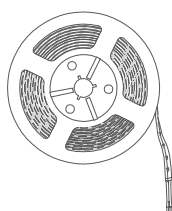

LED strip+accessories	Anti-static bag	Packing Box		
Part Number	Gross Weight per Reel	QTY per Carton	Size(cm/inch)	Gross Weight
SC-TSE1228-160-XX-24V	0.92Kg	20 Reels	35cm*35cm*35.5cm 13.78"*13.78"*13.98"	19.25Kg

## Installation requirement

- The strip itself and all its components may not be mechanically stressed;
- Routes on the circuit board can't be damaged or destroyed during installation;
- Installation of LED ribbon (with power supplies) needs to be made with regard to all applicable electrical and safety standards; Only qualified personnel should be allowed to perform installations;
- Correct electrical polarity needs to be observed. Wrong polarity may destroy the strip;
- Parallel connection is highly recommended as safe electrical operation mode;
- Serial connection is not recommended. Unbalanced voltage drop can cause hazardous overload and damage the strip;
- Please ensure that the power supply is of adapters power to operate the total load;
- When mounting on metallic or other conductive surfaces, there needs to be isolation points between strip and the mounting surface;
- Pay attention to standard ESD precautions when installing the strip;
- Damaged by corrosion will not be honored as a materials defect claim. It is the user's responsibility to provide suitable protection against corrosive agents such as moisture and condensation and other harmful elements;
- Caution needs to be taken while doing the connection after cutting the strip. Only authorized professionals can do the work to enable it waterproof in wet locations.



Yijia Industrial Park, Fuqian Road, Guanlan  
Town, LongHua, Shenzhen, Guangdong, China

Tel: +86-755-27608650  
Fax: +86-755-27608651  
[www.signcomplex.com](http://www.signcomplex.com)  
[sales@signcomplex.com](mailto:sales@signcomplex.com)

