

Morus

Installation manual

Installation Steps

- 1: Install the track to the ceiling as shown in picture 1.
- 2: Turn the power supply to off position as shown in picture 2a. Rotate the shift as shown in picture 2b, and assembly the track head into track as shown in picture 2c.
- 3: Rotate the shift to 90 degree as shown in picture 3.
- 4: Rotate off 1/2/3 as your requirement. Switch can rotate 360 degree clockwise and anticlockwise as shown in picture 4.
- 5: Installation is complete as shown in picture 5.

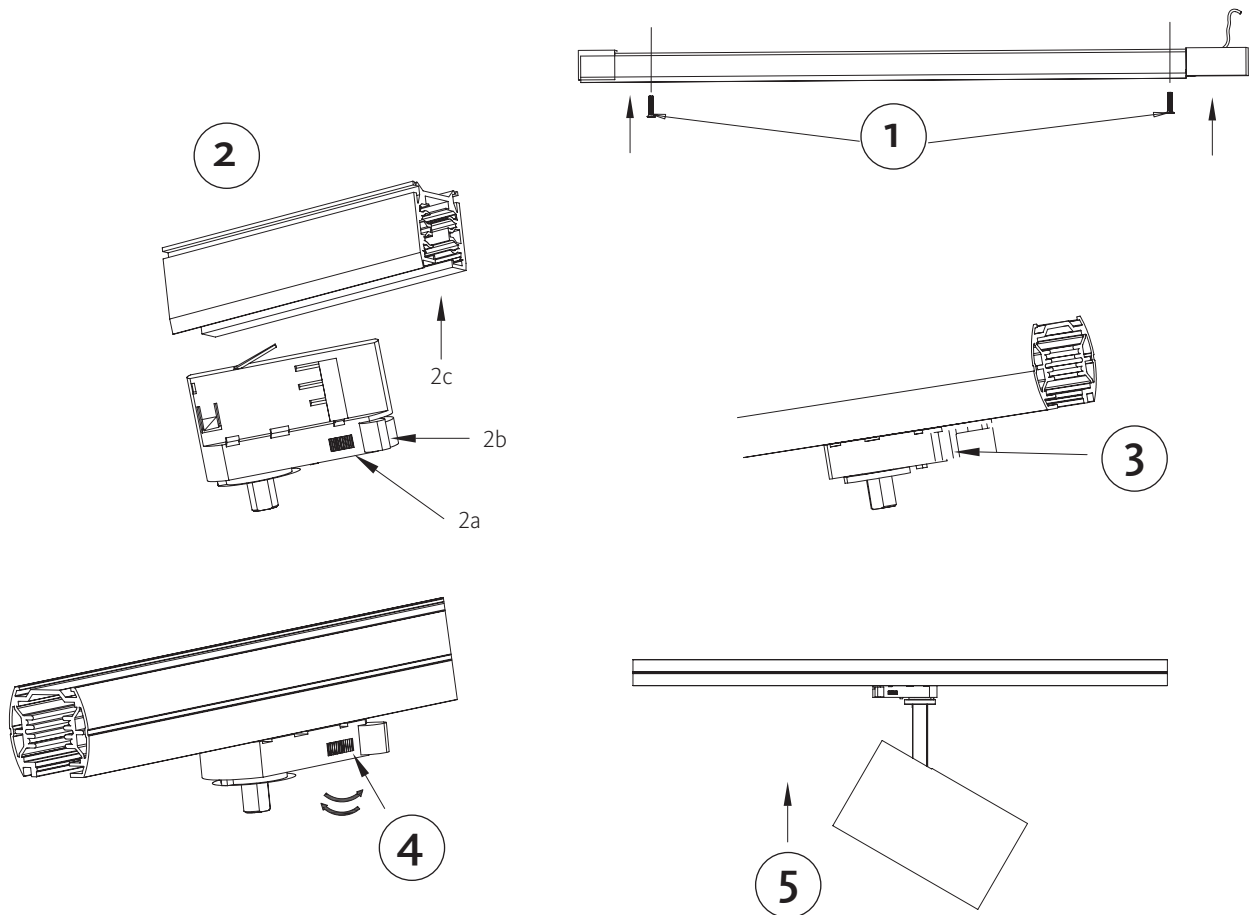

Morus

Disassemble steps

Disassemble Steps

- 1: Turn the power supply to off position as shown in picture 1.
- 2: Rotate the shift to 90 degree as shown in picture 2.
- 3: Pull out of the head of track downward as shown in picture 3.

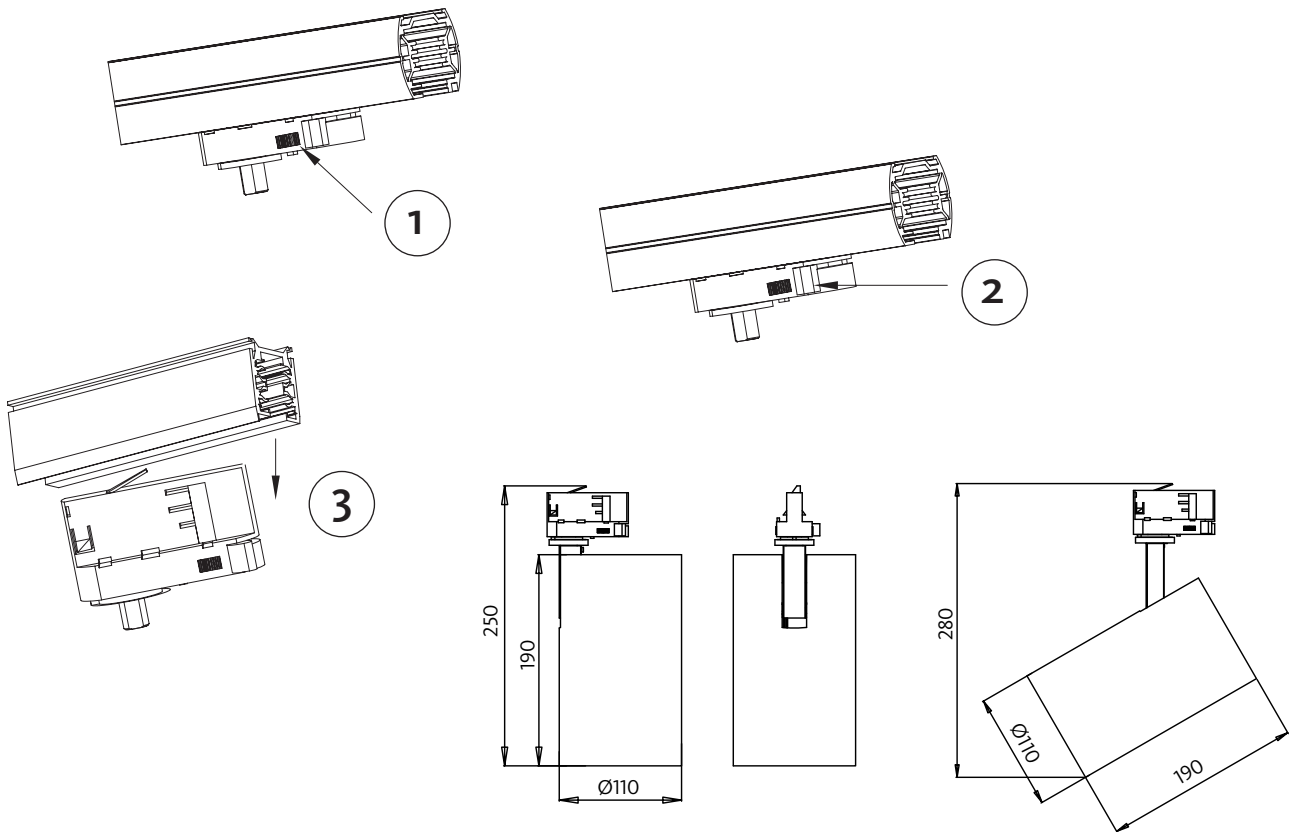

Cautions!

- 1: Make sure the power is disconnected between the spotlight and the track before spotlight disassembly.
- 2: The installation operator must hold a qualified electrician certificate.
- 3: Check the luminaire and accessories before installation. If there is any damage in lamp body or glass, please stop the installation.

