

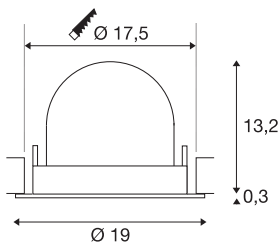

## NUMINOS® GIMBLE XL

black / chrome recessed ceiling light, 4000K 20°

NUMINOS is the optimally coordinated light system from SLV that combines function, design and technology. This way, you can experience a thousand lighting design possibilities with a variety of downlights and spotlights. Also with the NUMINOS® GIMBLE XL recessed ceiling light, which convinces with the best workmanship and lighting quality. Ideal for harmonious, modern and space-saving lighting that directs the accent to objects or the room. Installation is then done in no time at all. When will you choose SLV's modular variety?



## TECHNICAL DATA

Item no.	1006067
Number of different light outlets	1
Rotating or tilting	rotary bar and tiltable
Assembly	Recessed
Assembly details	Ceiling
Secondary power / voltage	1000/1050 mA
Safety class	III
Wattage	37.4 W
Lumen	3750 lm
Colour temperature	4000 Kelvin
Beam angle	20 °
Color	black
CRI	90
UGR ≤	22
LXXBXX data	L80B50
Risk Group	1
Height	13.5 cm
Diameter	19 cm
Net weight	0.85 kg
Gross weight	1 kg
Shape of cut-out	round
Installation depth	13.5 cm

## Light Source

791850	
--------	---

## Accessories

1004059	LED driverm 40W multi mA
1004066	LED driver , 28-40W 1000mA PHASE
1004071	LED driver 4.2-50W 1050mA DALI
1004798	NUMINOS® XL , diffuser Ellipse
1004799	NUMINOS® XL , diffuser Prisma
1004800	NUMINOS® XL , diffuser Frosted
1004801	NUMINOS® XL , diffuser Wabe
1006151	Numinos® XL Reducing ring , round 240/180mm black
1006152	Numinos® XL Reducing ring , round 240/180mm white
1006153	Numinos® XL Reducing ring , square 240/180mm black
1006154	Numinos® XL Reducing ring , square 240/180mm white

Installation diameter	17.5 cm
BIG WHITE Page	57