

ATEXOR code	SF2LED
Product description	Explosion protected luminary for fixed use
ATEX marking	 Ex II 2 G Ex e mb op is IIC T4 Gb Ex II 2 D Ex tb op is IIIC T90°C Db
Temperature classification	T4 (internal) T90 °C (external)
Operating temperature	-40°C ... +40°C
Light source	2 Led module with SafeEye® technology
Light emitted at source	approx. 5650 lm
Luminous flux (measured)	3140 lm
Colour temperature	4600 - 5700 K
Colour rendering index	>80
Photobiological safety	Exempt group (No marking required, safe in normal use)
Supply Voltage	110VAC/DC, 230VAC +/- 6%, 50/60Hz
Supply Current (typical)	110V~0,45A. 230V~0,2A
Electrical class	Class 1 (110VAC/DC, 230 VAC)
Power	< 50 W
Cable	MCMK 2x2,5/2,5 or equivalent for fixed use
Cable gland	M25 (for 10-17mm ø cable), installed with cable.
Plug and socket	Not applicable
Enclosure	Dissipative materials (PC & TPE)
Ingress protection	IP66
IK class	08
Weight (without cable and fixings)	3,4 kg
Accessories	70905 ceiling fixing 70904 pole fixing

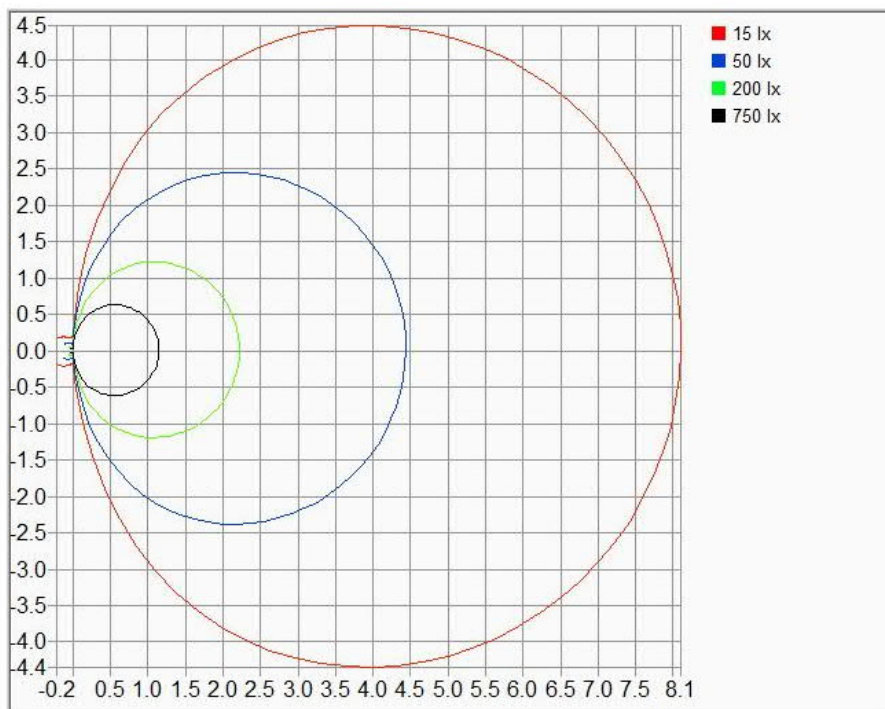

Product model	Dimensions / mm	
	L	Ø
SLAM FIXED® Nordic 2LED WS	1020	115

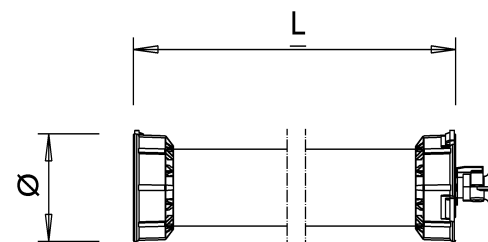



Datasheet
SLAM FIXED® Nordic 2LED WS



Made in Finland by ATEXOR Oy

27/08/2021

Tel: +358 207 343250, E-mail: info@atexor.com www.atexor.com

ATEXOR Oy prepared this information herein in good faith but makes no representation as to its comprehensiveness or accuracy. ATEXOR Oy reserves the right to make changes to specifications and product descriptions at any time without notice. Ask for more technical data from our sales support.