

ATEXOR order code	SFN2LEDA230...
Product description	Explosion protected luminary for fixed use
ATEX and IECEx marking	 Ex II 2 G Ex eb mb op is IIC T4 Gb Ex II 2 D Ex tb op is IIIC T90°C Db
Temperature classification	T4 (internal) T90 °C (external)
Operating temperature	-40°C ... +55°C
Light source	2 Led modules with SafeEye® technology
Light emitted at source	5650 lm
Luminous flux (measured)	3140 lm
Colour temperature	4600 - 5700 K
Colour rendering index	>80
Photobiological safety	Exempt group (No marking required, safe in normal use)
Supply Voltage	230VAC/DC +/- 6%, 50/60Hz
Supply Current (typical)	230V~0,25 A
Electrical class	Class 1
Power	< 50 W
Cable	Upto 5x4mm ² . 1x M25 cable gland, ø9-17mm, delivered with blanking plug.
Enclosure	Dissipative materials (PC & TPE)
Ingress protection	IP66
Weight (without cable and fixings)	3,4 kg
Accessories	70918 extended ceiling fixing 70908 pole fixing 70908_1 pole fixing, pole above fixing

Product model	Dimensions / mm	
	L	Ø
SLAM® FIXED Novo 2LED A	1100	112

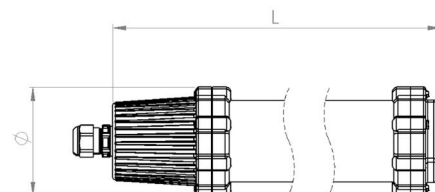

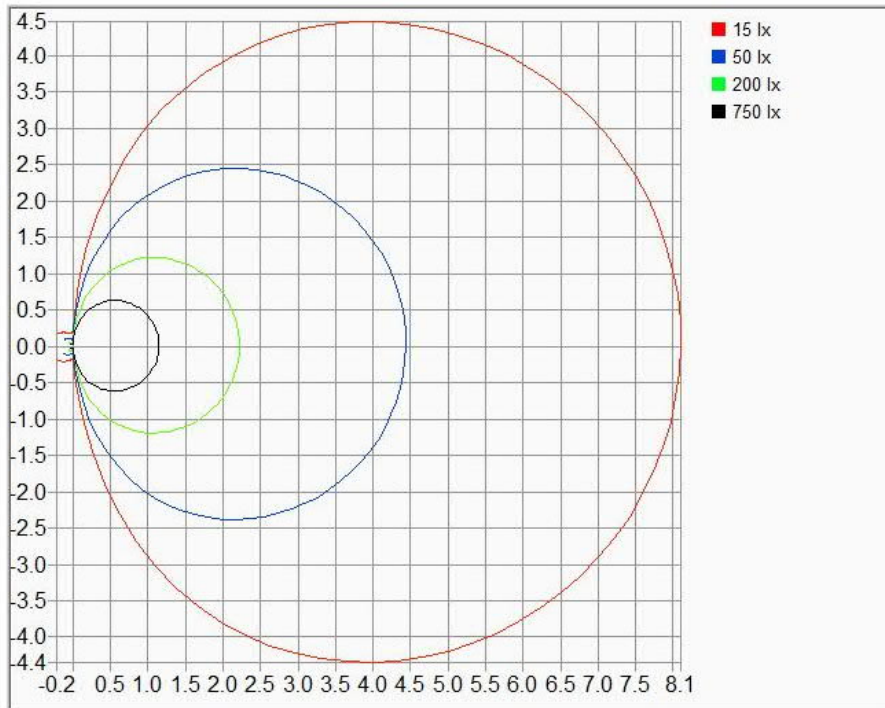



Datasheet
SLAM FIXED Novo 2LED A



Made in Finland by ATEXOR Oy

22/11/2022

Tel: +358 207 343250, E-mail: info@atexor.com www.atexor.com

ATEXOR Oy prepared this information herein in good faith but makes no representation as to its comprehensiveness or accuracy. ATEXOR Oy reserves the right to make changes to specifications and product descriptions at any time without notice. Ask for more technical data from our sales support.