

ATEXOR code	SFN2LEDB230....
Product description	Explosion protected luminary for fixed use with throughwiring
ATEX marking	 Ex II 2 G Ex eb mb op is IIC T4 Gb Ex II 2 D Ex tb op is IIIC T90°C Db
Temperature classification	T4 (internal) T90 °C (external)
Operating temperature	-40°C ... +55°C
Light source	2 Led modules with SafeEye® technology
Light emitted at source	5650 lm
Luminous flux (measured)	3140 lm
Colour temperature	4600 - 5700 K
Colour rendering index	>80
Photobiological safety	Exempt group (No marking required, safe in normal use)
Supply Voltage	230VAC/DC +/- 6%, 50/60Hz
Supply Current (typical)	230V~0,1 A
Electrical class	Class 1 (230 VAC)
Power	< 50 W
Cable	up to 5x4mm <sup>2</sup> . 2x M25 cable gland, ø9-17mm. Delivered with blanking plugs. Throughwiring 5x2,5mm <sup>2</sup> .
Enclosure	Dissipative materials (PC & TPE)
Ingress protection	IP66
Weight (without cable and fixings)	app. 3,7kg
Accessories	70918 extended ceiling fixing 70908 pole fixing 70908_1 pole fixing, pole above

	Dimensions / mm	
Product model	L	Ø
SLAM® FIXED Novo 2LED B	1168	112

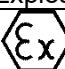

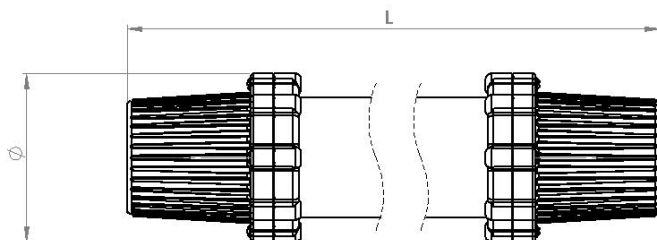

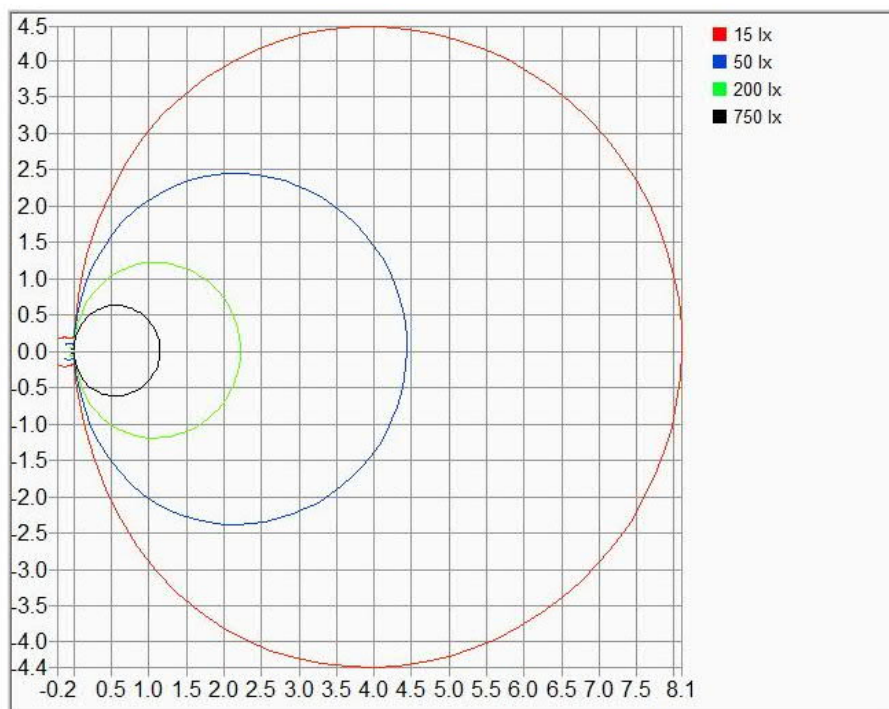

*Picture 1. 70908 Pole fixing*



*Picture 2. 70908\_1 Pole fixing, pole above the bracket*



*Picture 3. 70918 extended ceiling/wall fixing*