

once®

BioShift UV-C Disinfection Chamber

24-0200 / 24-0201

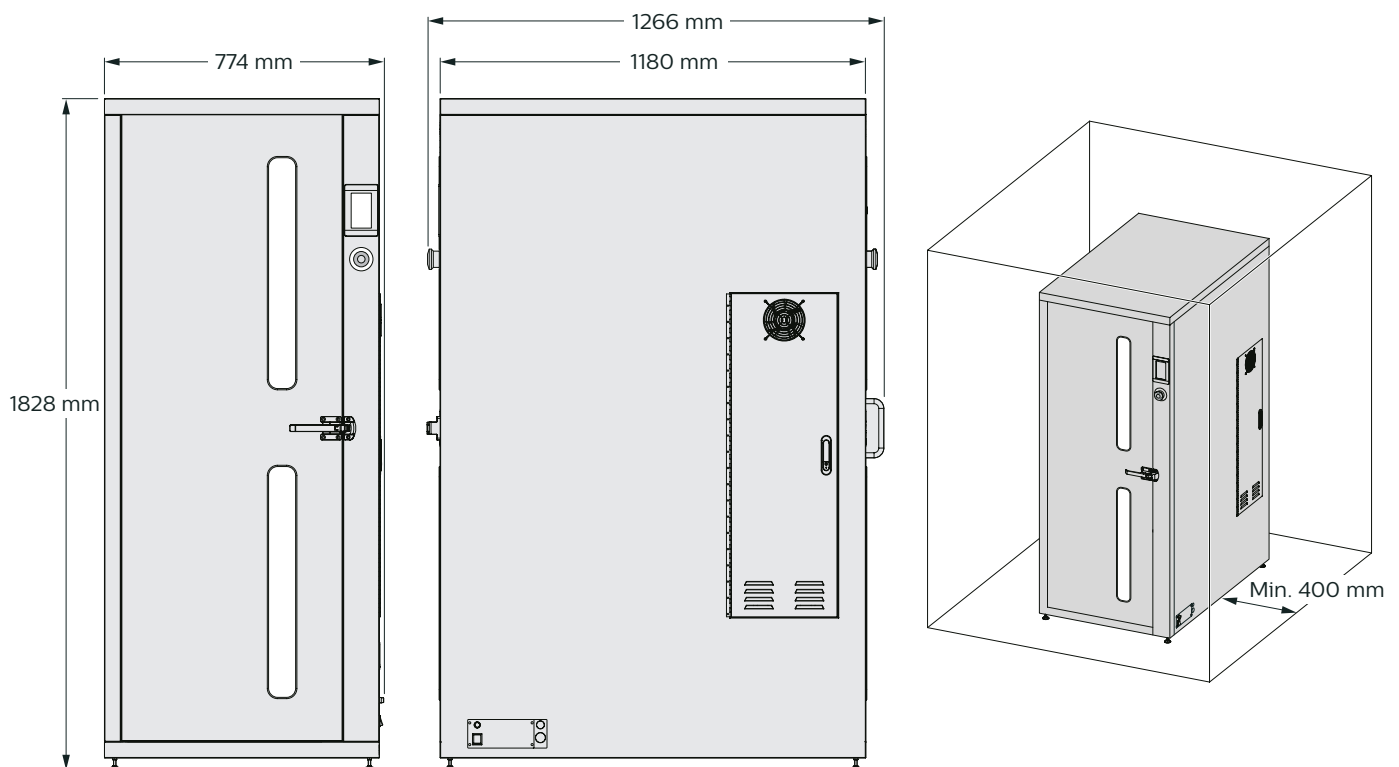

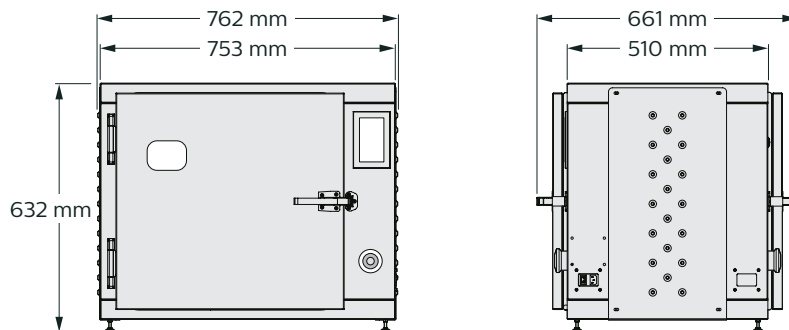
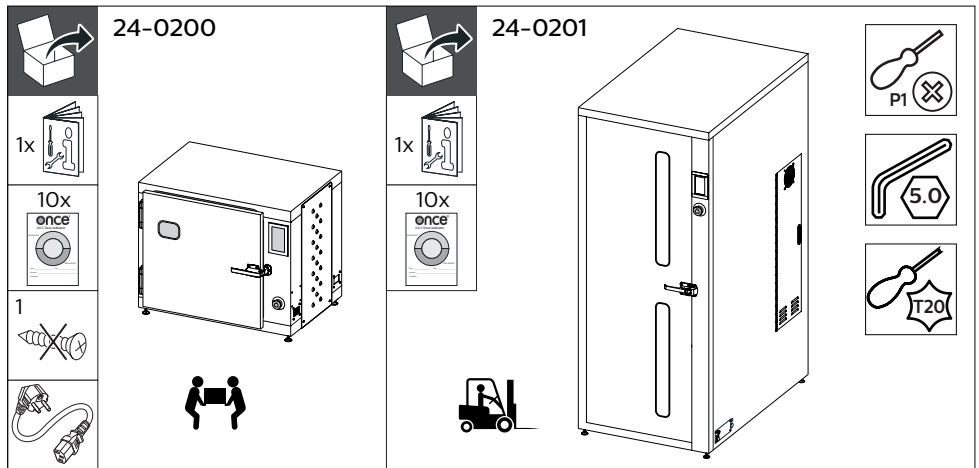
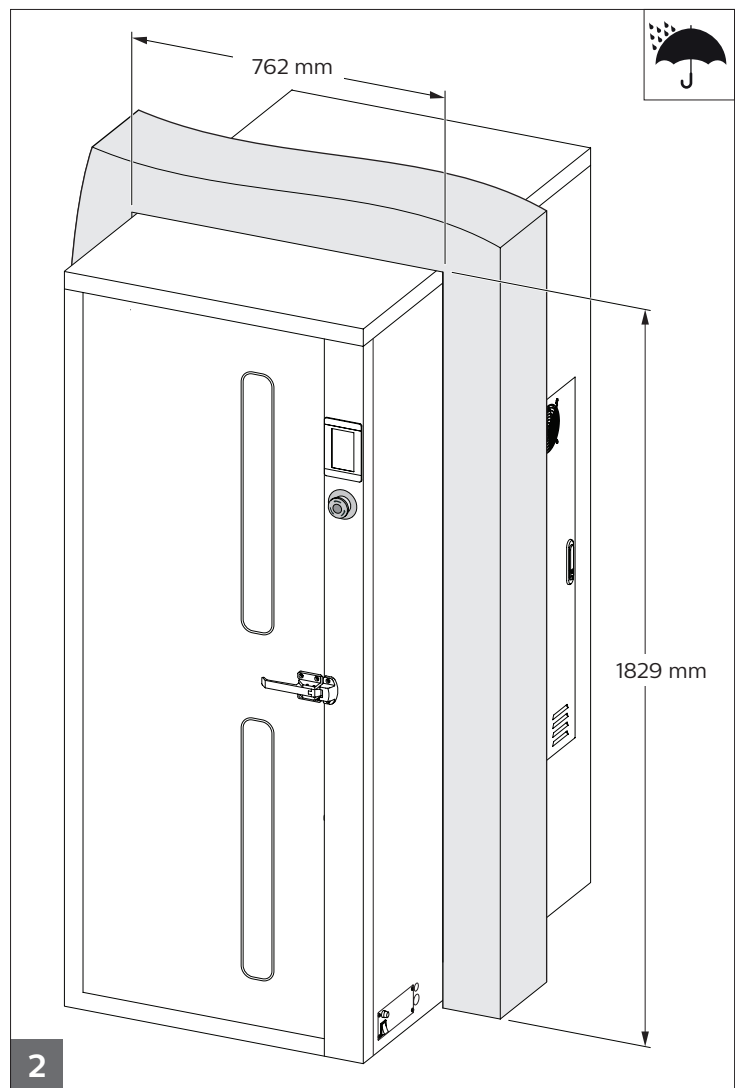
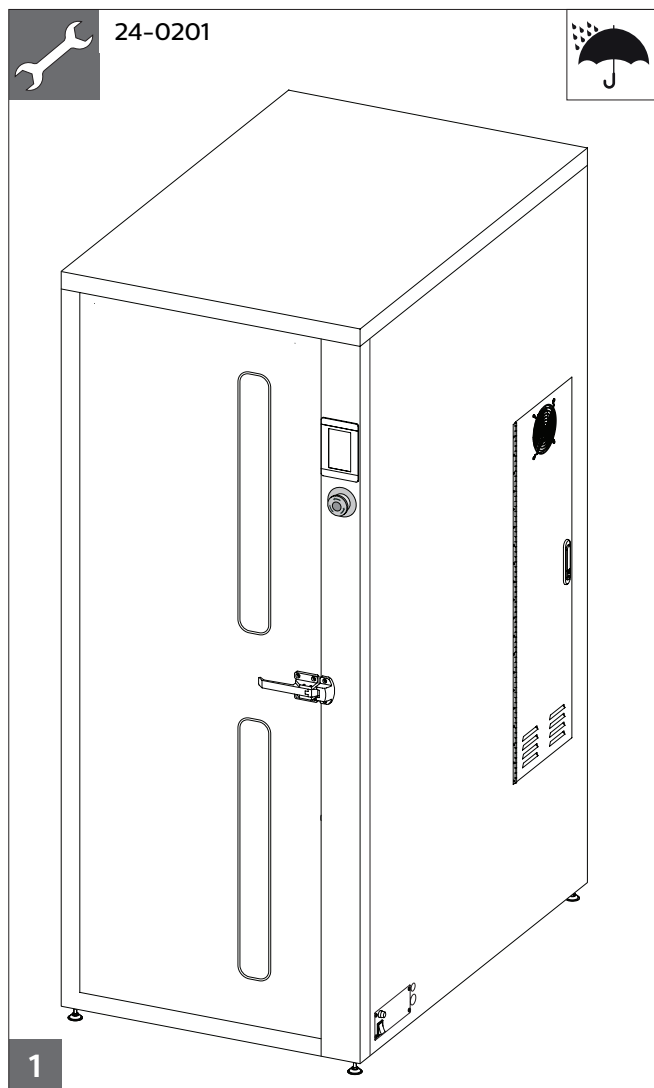
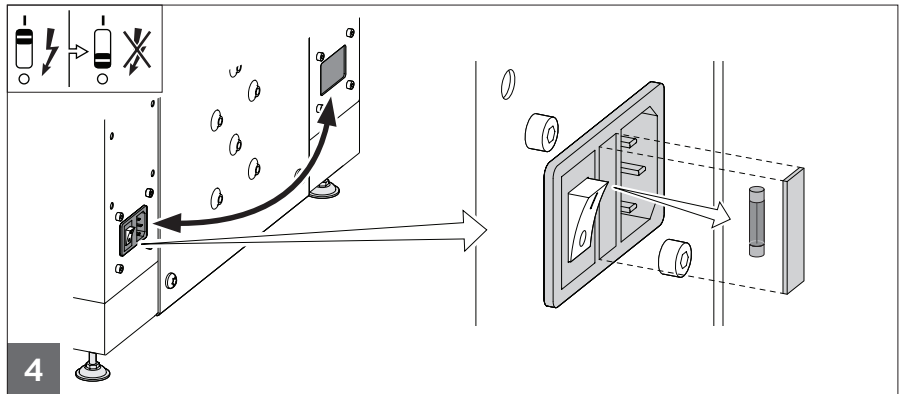
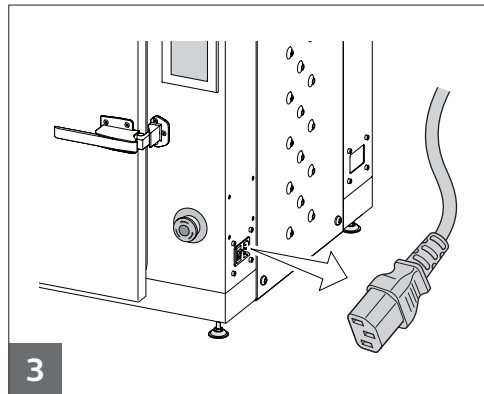
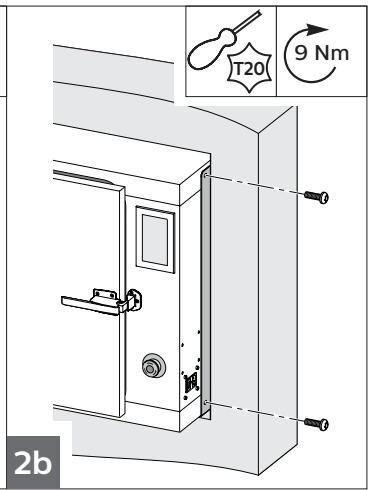
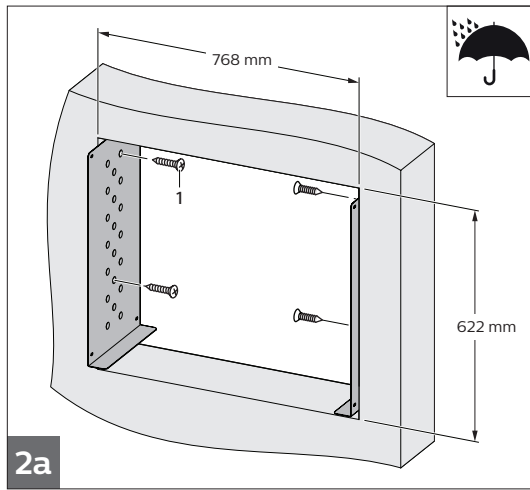
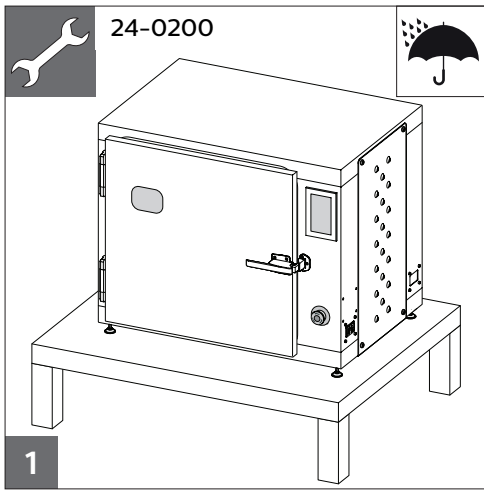

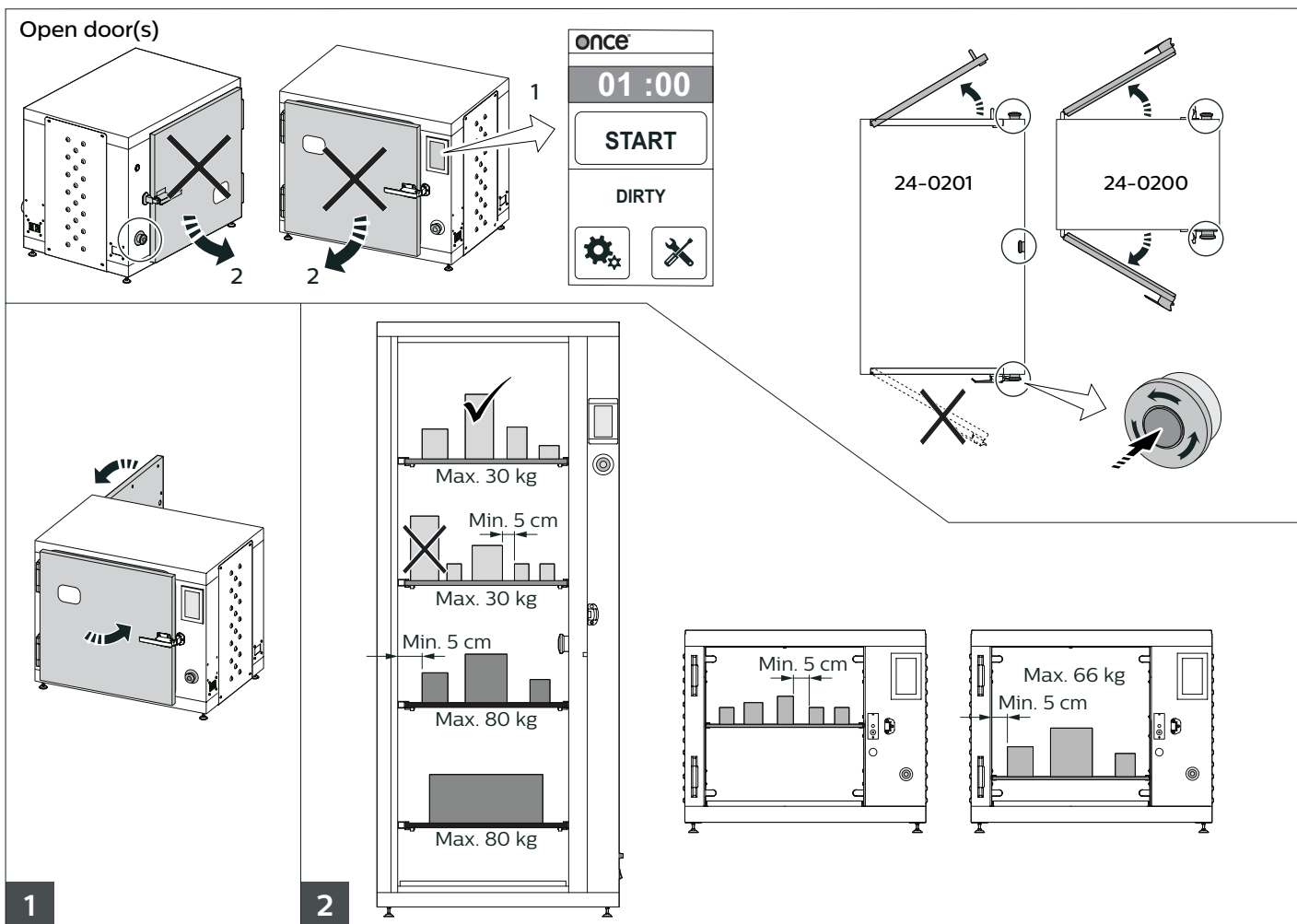
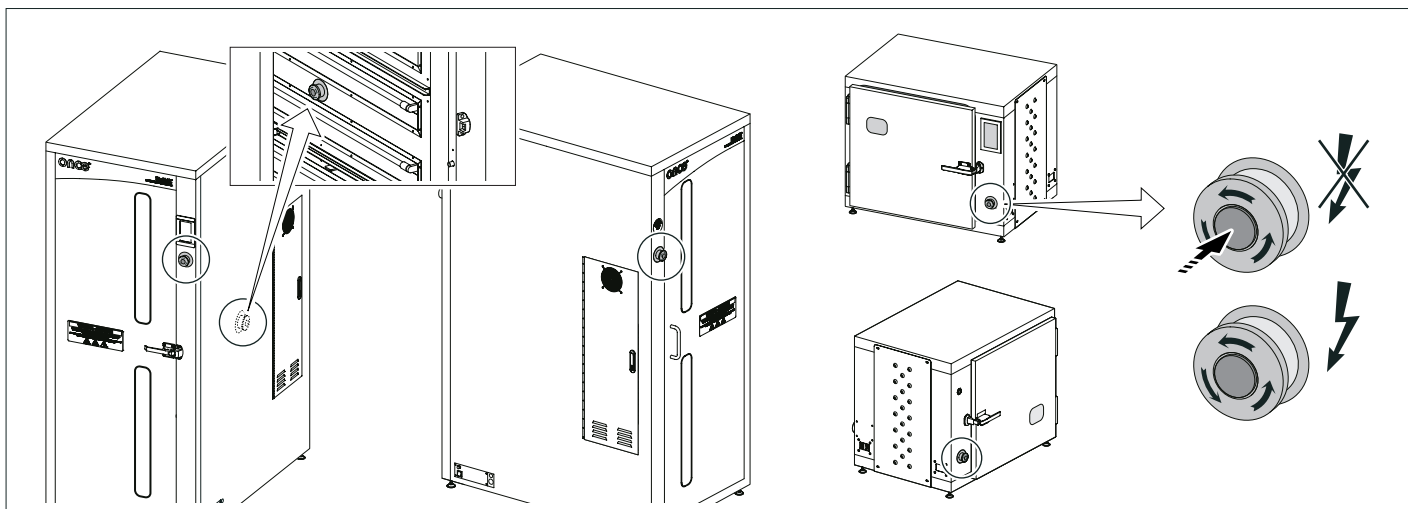
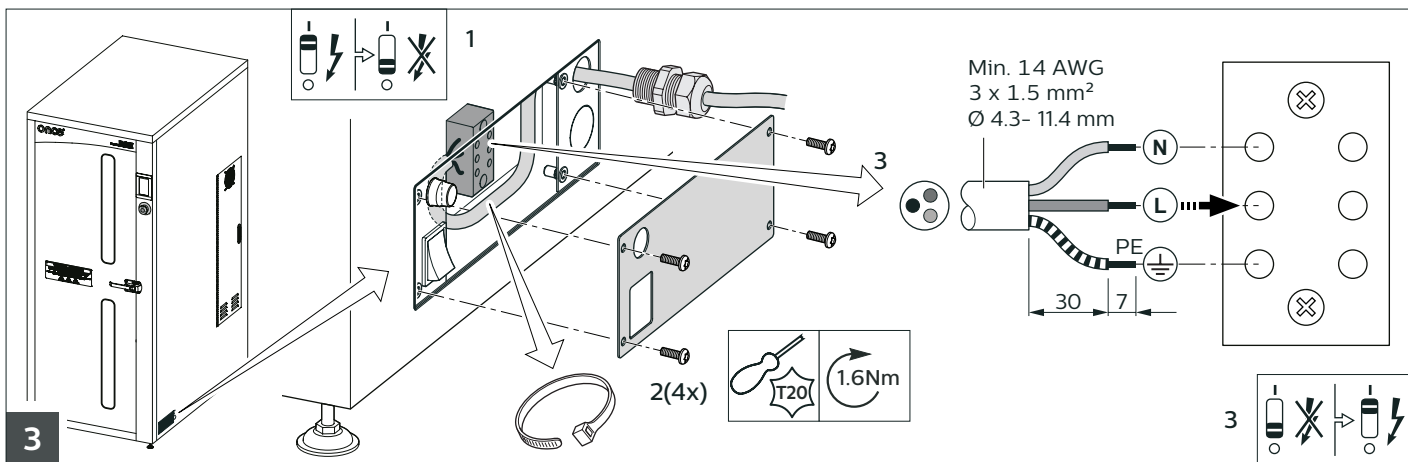

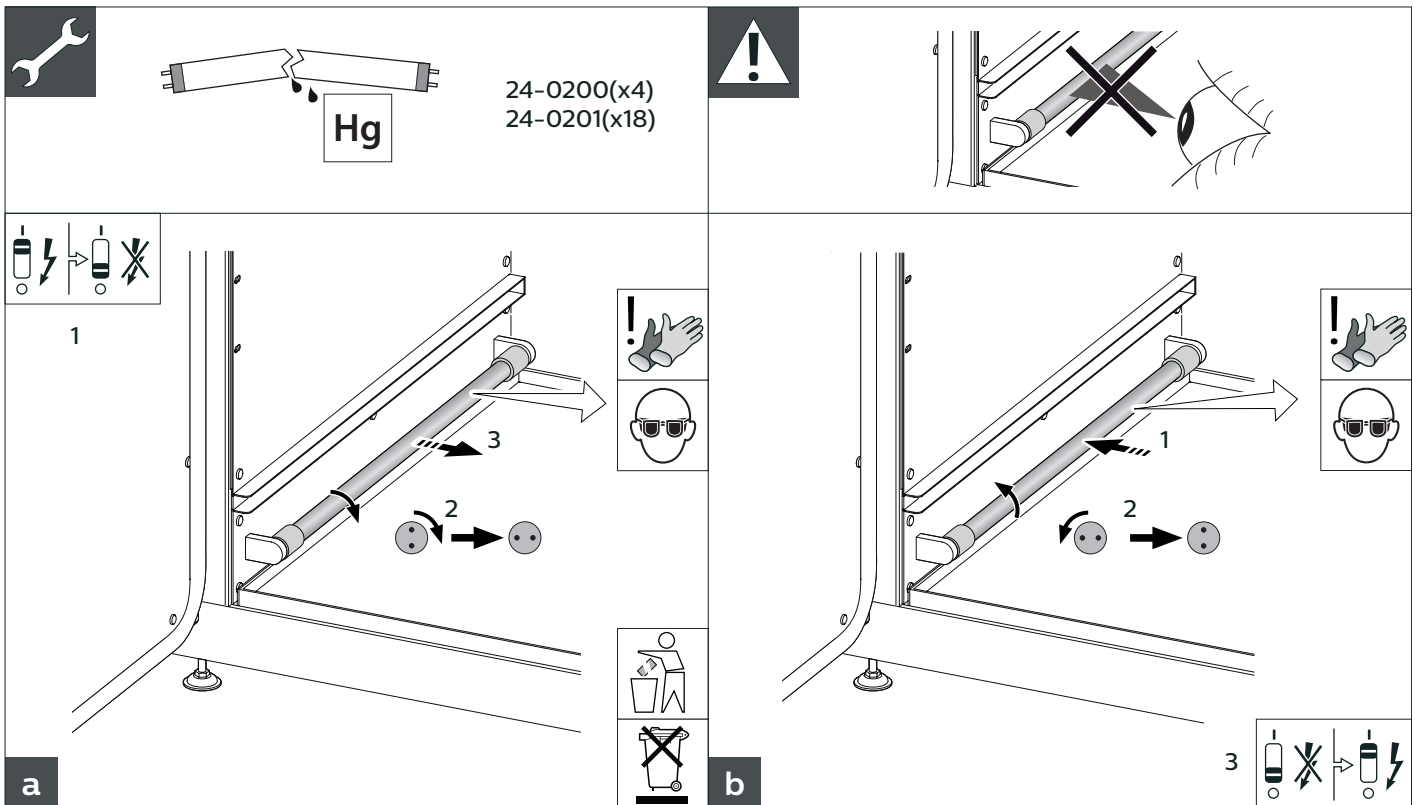
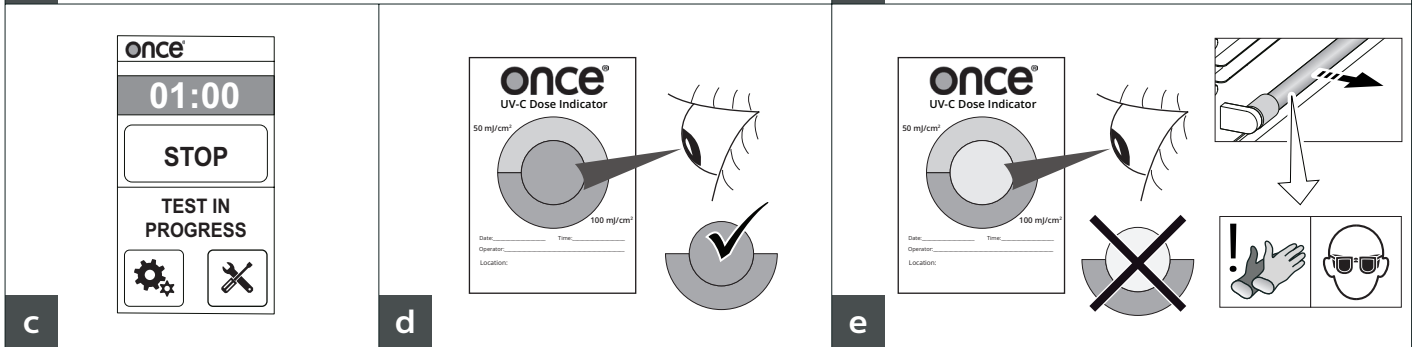
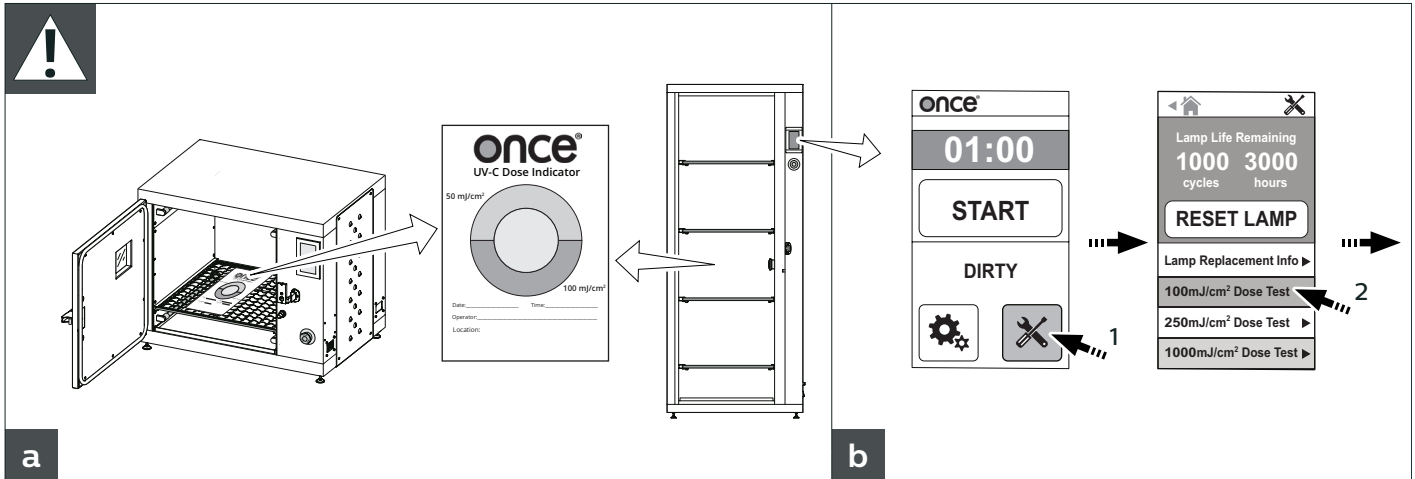
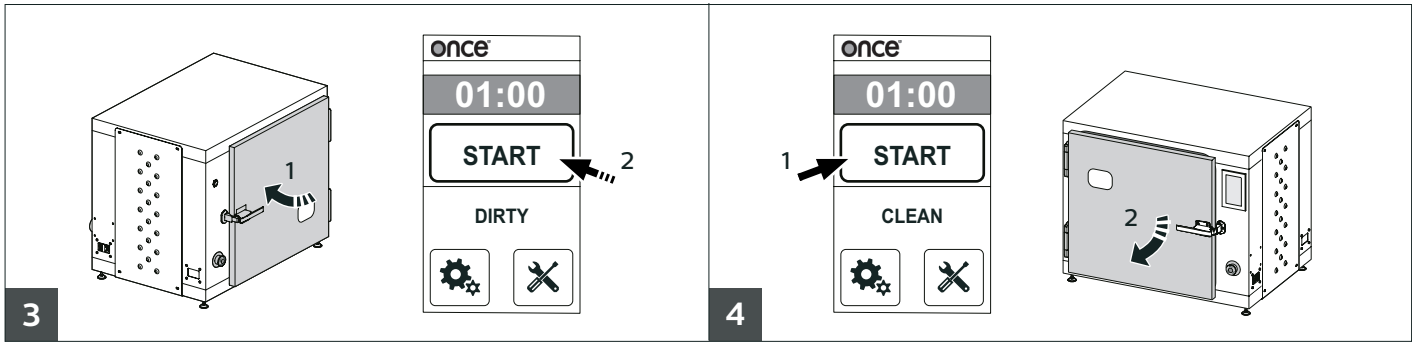

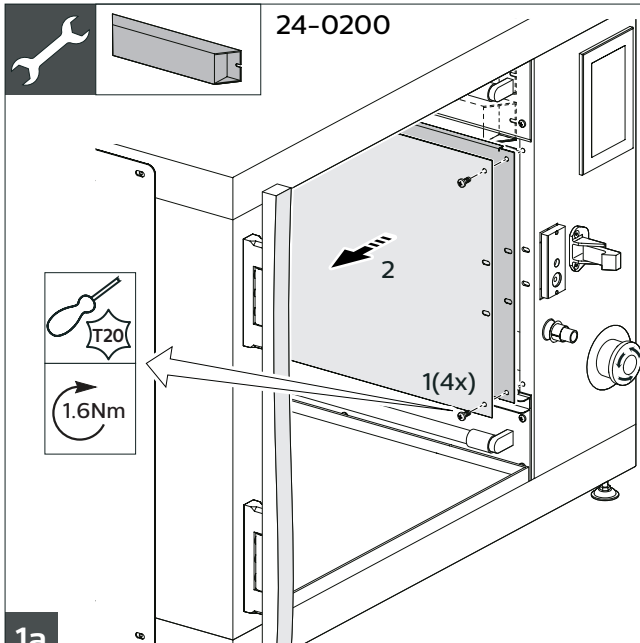

24-0201

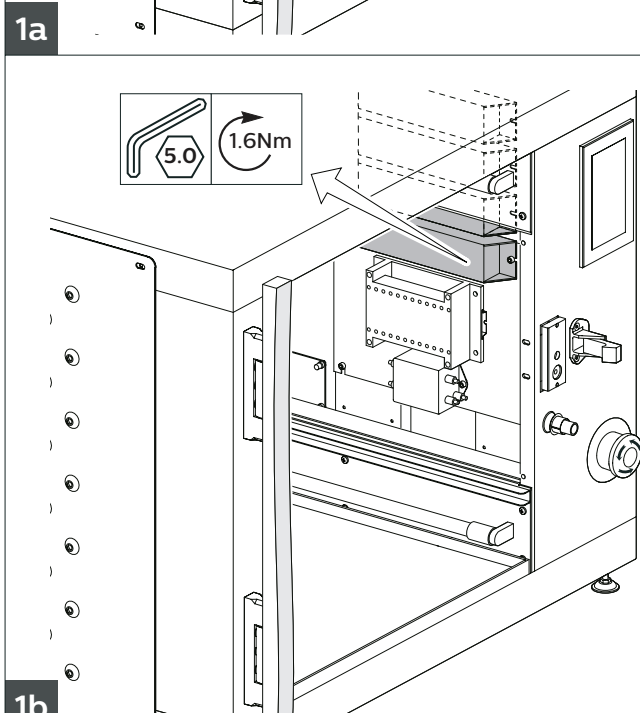
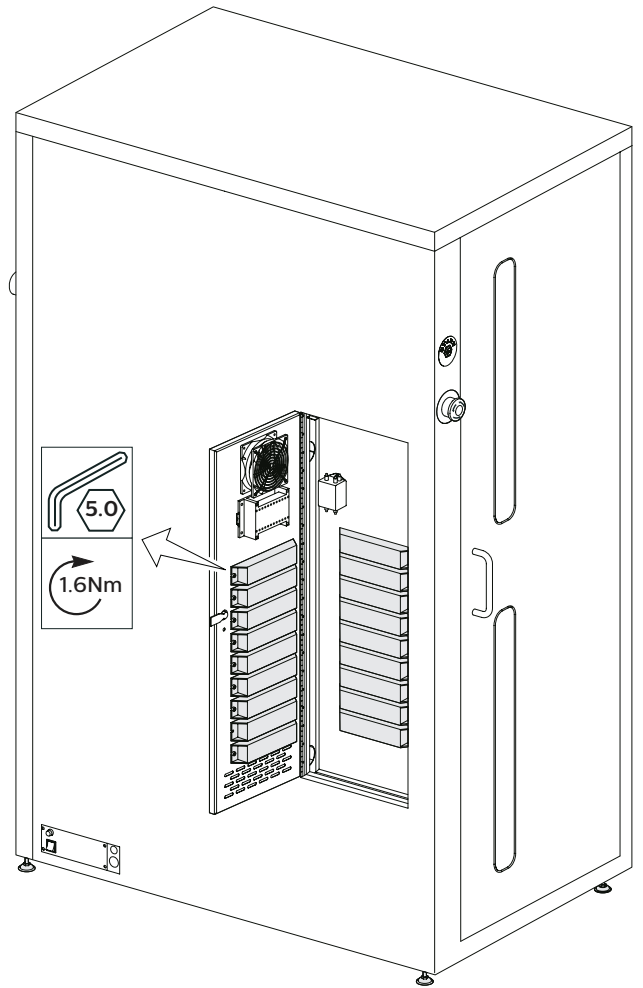

2

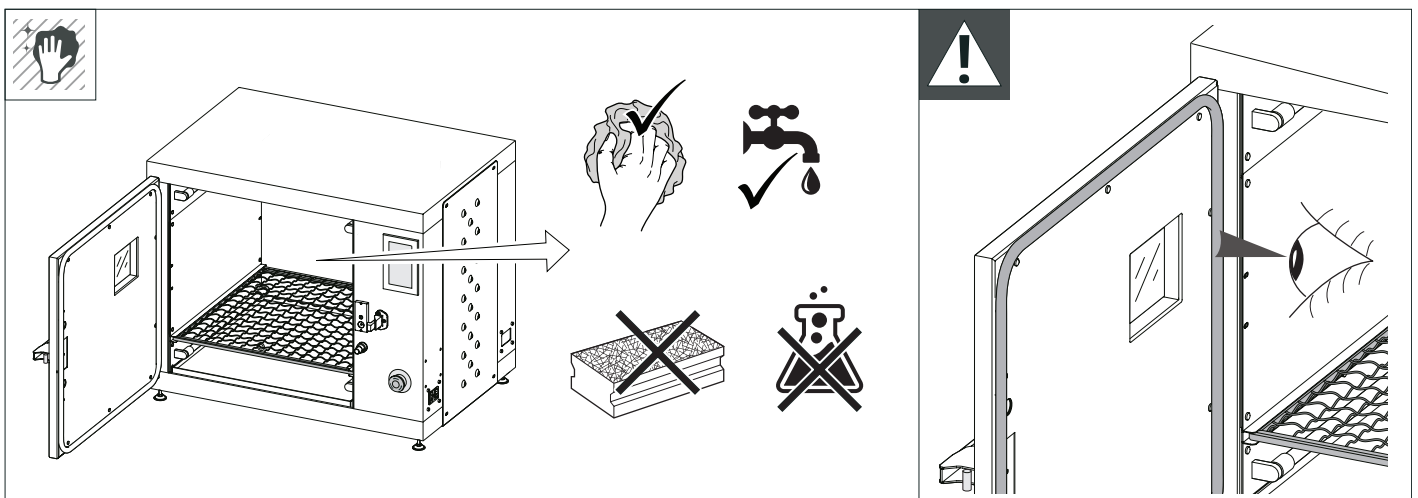

The luminaire shall be installed by a qualified electrician and wired in accordance with the latest IEE electrical regulations or the national requirements.



© 2020 Signify Holding.

All rights reserved. This document contains information relating to the product portfolio of Signify which information may be subject to change. No representation or warranty as to the accuracy or completeness of the information included herein is given and any liability for any action in reliance thereon is disclaimed. The information presented in this document is not intended as any commercial offer and does not form part of any quotation or contract. ONCE and ONCE Innovations Inc. are registered trademarks owned by Signify Holding.

Signify Holding.
The Netherlands