

FRONT

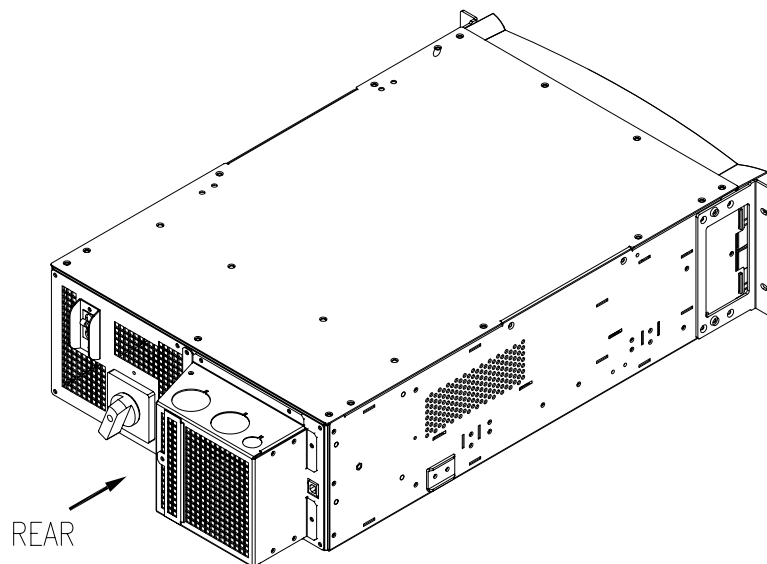

REAR

ISOMETRIC VIEWS (RACK MOUNT)

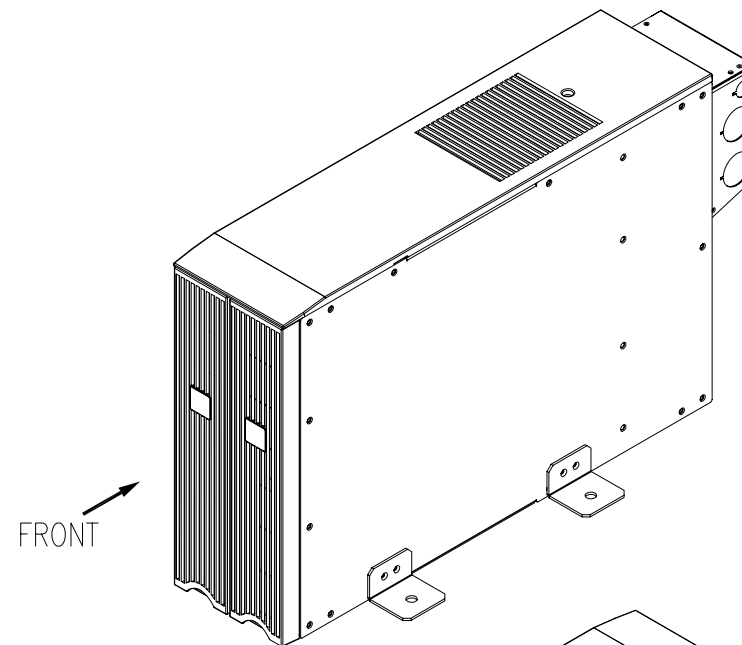

FRONT

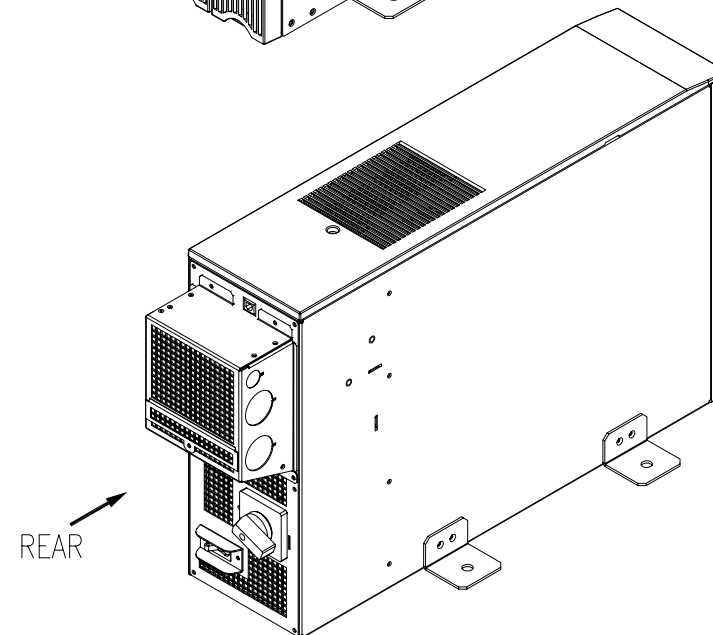

REAR

ISOMETRIC VIEWS (TOWER MOUNT)

NOTES:

1. PLEASE REFER TO APC PRODUCT MANUAL FOR DETAILS.
2. INSTALLATION MUST COMPLY WITH NATIONAL AND LOCAL ELECTRICAL REGULATIONS.

THIS DRAWING AND SPECIFICATIONS HEREIN ARE THE PROPERTY OF AMERICAN POWER CONVERSION AND SHALL NOT BE COPIED, REPRODUCED OR USED IN WHOLE OR IN PART, AS THE BASIS FOR THE MANUFACTURE OR SALE OF ITEMS WITHOUT WRITTEN PERMISSION FROM APC. THIS DRAWING IS BASED UPON LATEST AVAILABLE INFORMATION AND IS SUBJECT TO CHANGE WITHOUT NOTICE.

APC
www.apc.com

TITLE:
ISOLATION TRANSFORMER 20KVA
INPUT: 200-240V AC 2PH/400V AC 2PH
OUTPUT: 200-240V AC/120V AC
ISOMETRIC VIEW

PROJECT: SUBMITTAL DRAWINGS SHEET 1 OF 3

DWG NO: APTF20KW01-MM1 REV. 0

DRAWN: JAYAPRAKASH 25-SEP-07

ENGINEER: K.WHITE/B.BUNGCHAYAO 04-OCT-07

APPROVED: M.TAVARES 04-OCT-07

FIRST
ANGLE
PROJECTION

RACK MOUNT CONFIGURATION

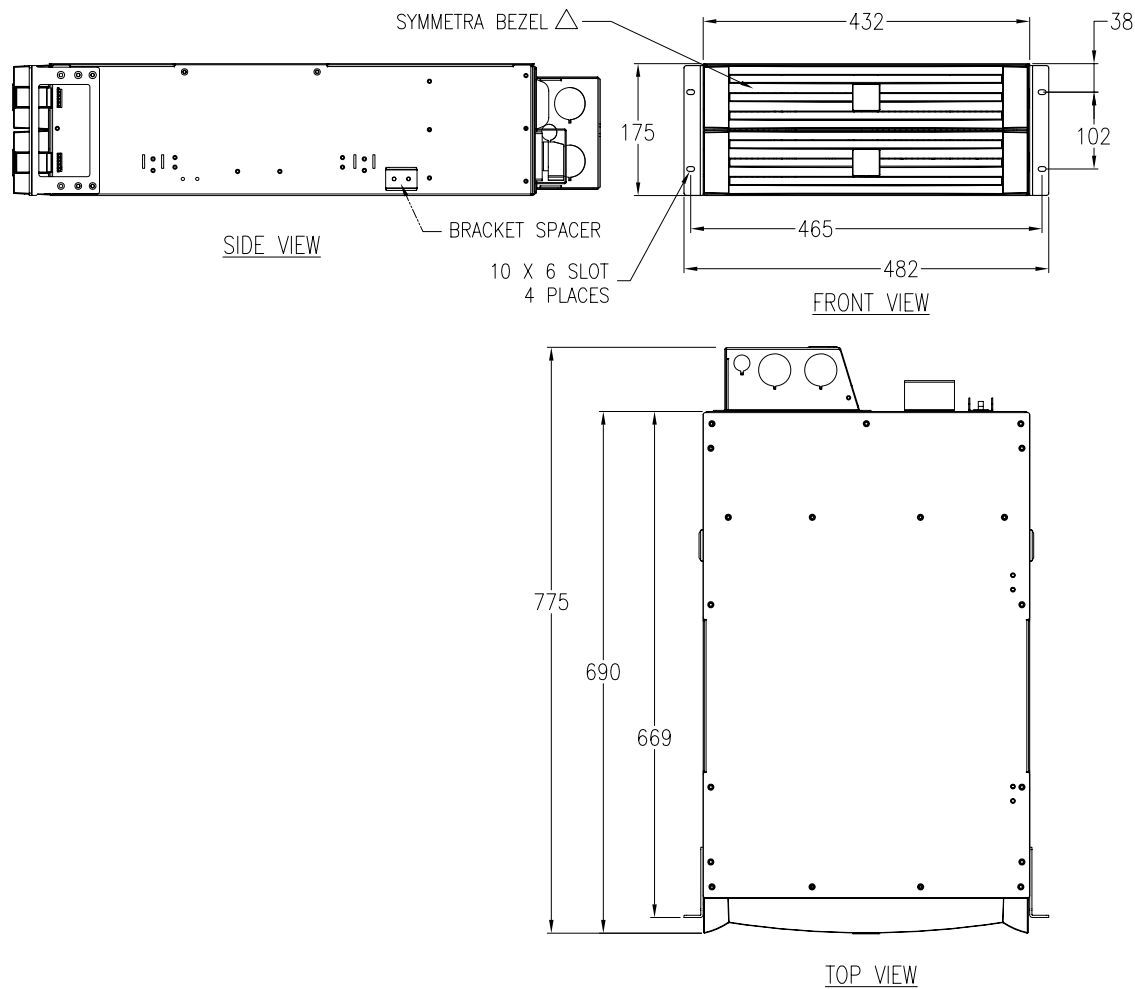

TOWER MOUNT CONFIGURATION

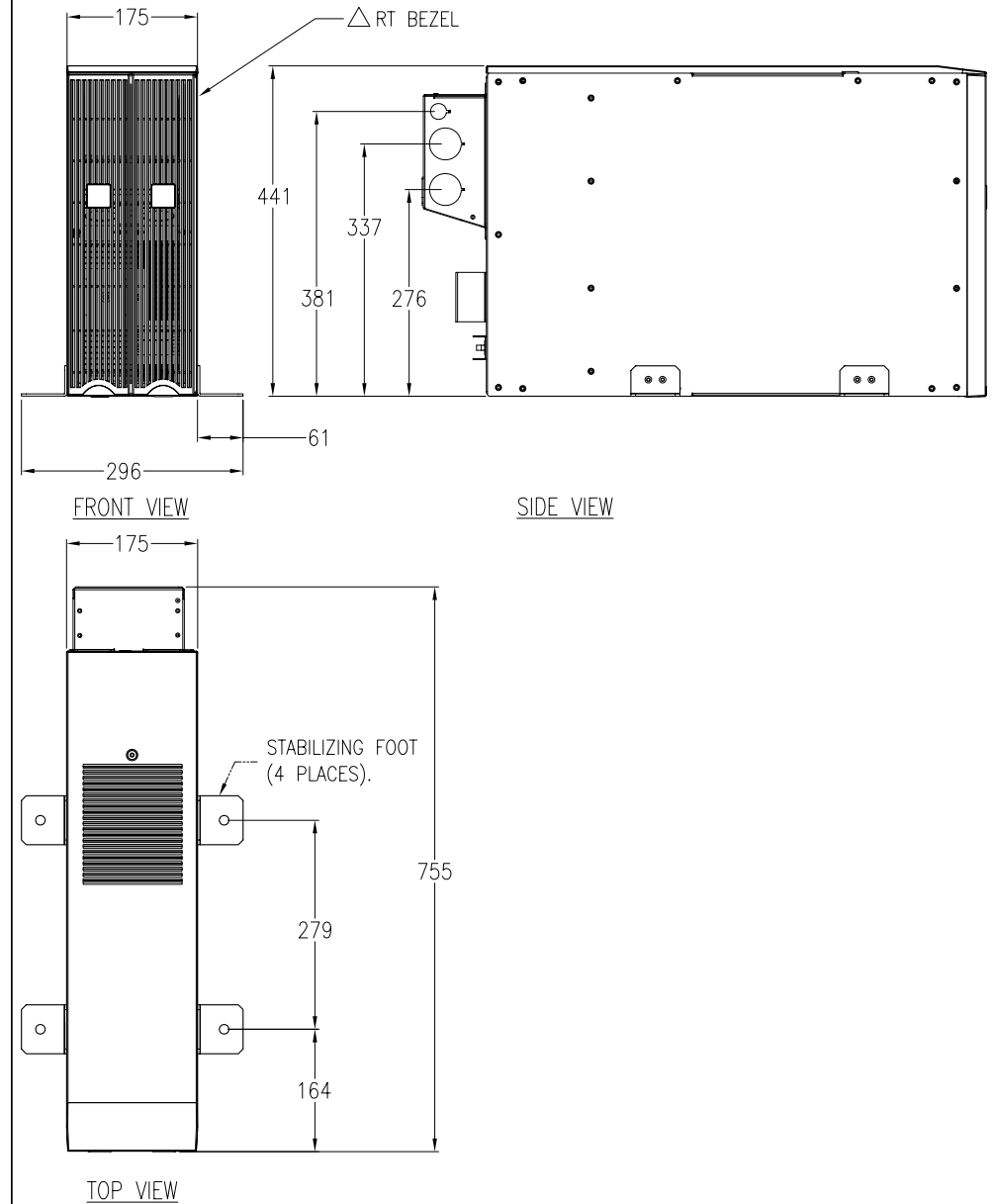

NOTES:

1. PLEASE REFER TO APC PRODUCT MANUAL FOR DETAILS.
2. ALL DIMENSIONS ARE IN MILLIMETERS.
3. WEIGHT OF UNIT IS 118.18 kg.
4. UNIT SHIPPED WITH BOTH RT AND LYNX BEZELS.
- △ 5. EITHER SYMMETRA BEZELS OR RT BEZELS CAN BE USED FOR THIS OPTION.
6. INSTALLATION MUST COMPLY WITH NATIONAL AND LOCAL ELECTRICAL REGULATIONS.

THIS DRAWING AND SPECIFICATIONS HEREIN ARE THE PROPERTY OF AMERICAN POWER CONVERSION AND SHALL NOT BE COPIED, REPRODUCED OR USED IN WHOLE OR IN PART, AS THE BASIS FOR THE MANUFACTURE OR SALE OF ITEMS WITHOUT WRITTEN PERMISSION FROM APC. THIS DRAWING IS BASED UPON LATEST AVAILABLE INFORMATION AND IS SUBJECT TO CHANGE WITHOUT NOTICE.

APC
www.apc.com

TITLE:
ISOLATION TRANSFORMER 20KVA
INPUT: 200-240V AC 2PH/400V AC 2PH
OUTPUT: 200-240V AC/120V AC
MAIN MECHANICAL
PROJECT: SUBMITTAL DRAWINGS SHEET 2 OF 3

DWG NO: APTF20KW01-MM2
DRAWN: JAYAPRAKASH 25-SEP-07
ENGINEER: K.WHITE/B.BUNGAYAO 04-OCT-07
APPROVED: M.TAVARES 04-OCT-07

REV: 0
FIRST ANGLE PROJECTION

TYPICAL DETAILS FOR RACK MOUNT AND TOWER MOUNT CONFIGURATION

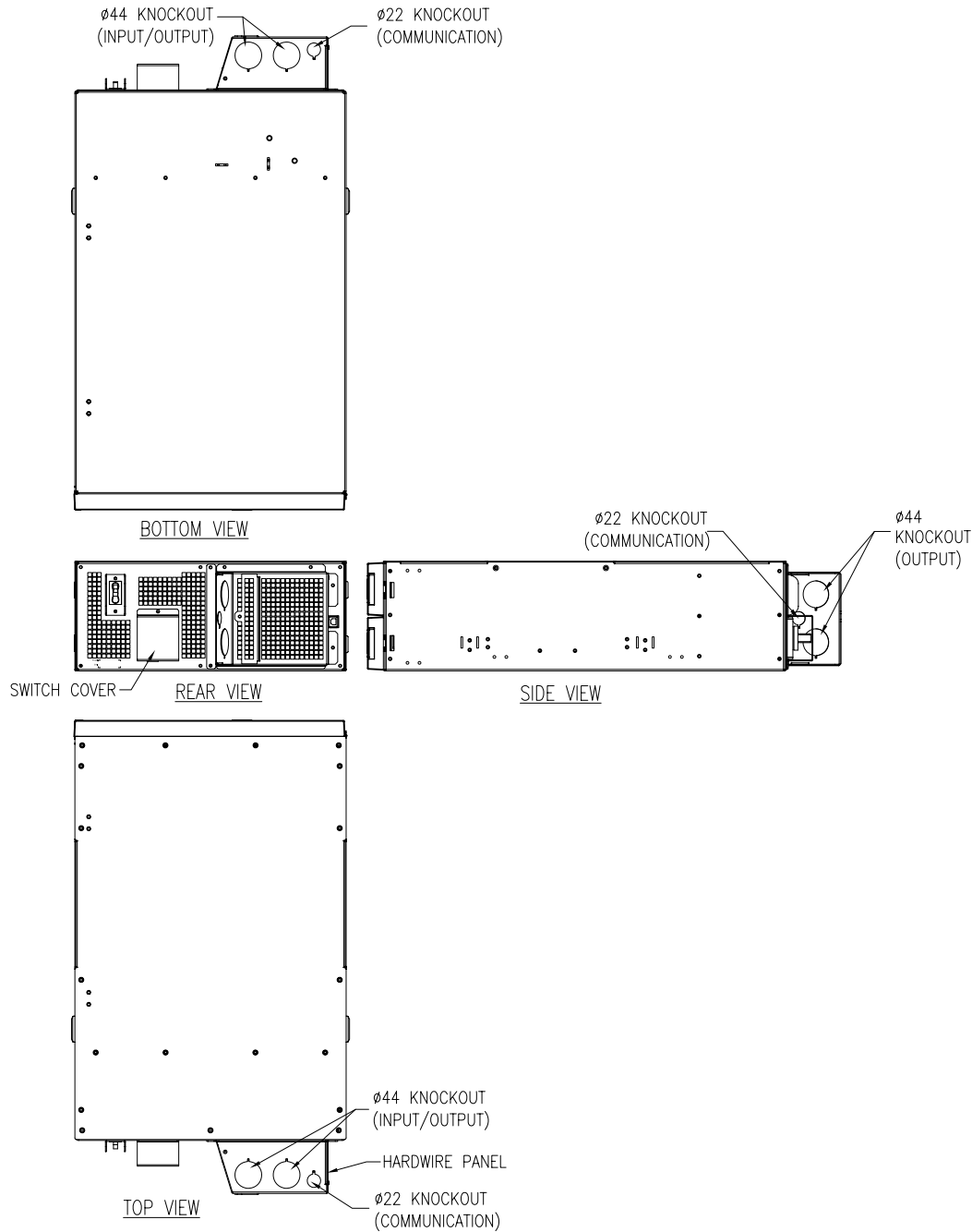

NOTES:

1. PLEASE REFER TO APC PRODUCT MANUAL FOR DETAILS.
2. ALL DIMENSIONS ARE IN MILLIMETERS.
3. INSTALLATION MUST COMPLY WITH NATIONAL AND LOCAL ELECTRICAL REGULATIONS.

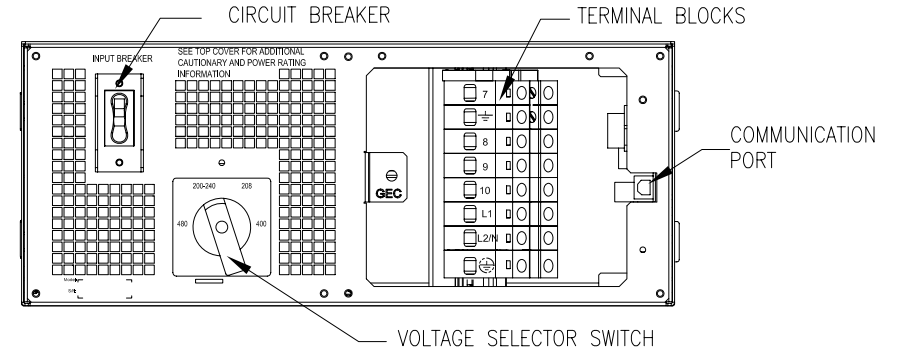

REAR VIEW (ENLARGED)
(WITHOUT HARDWIRE PANEL & SWITCH COVER)

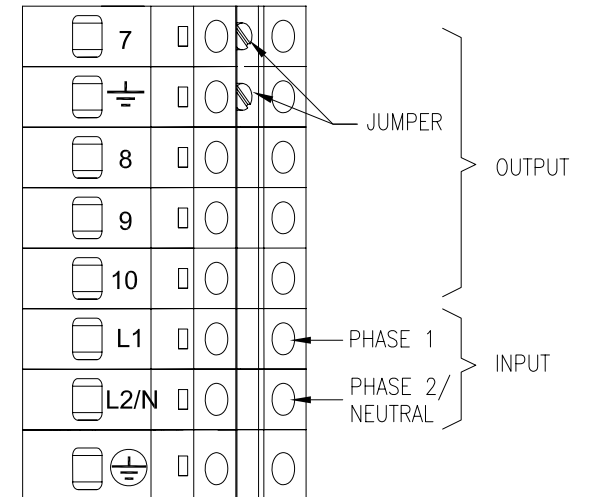

TERMINAL BLOCKS (ENLARGED VIEW)

TERMINAL BLOCK CONNECTIONS FOR OUTPUT
TORQUE REQUIRED IS 1.5 N-m

| INPUT NO OF PHASE | INPUT VOLTAGE (AC) | | OUTPUT VOLTAGE AT 100A (20kVA UNITS) | | | |
|----------------------|--------------------|-------------------------------------|--------------------------------------|------|----------|----------|
| | SWITCH POSITION | SWITCH CONTACTS (CLOSE POSITION) | TERMINAL BLOCK CONNECTIONS | | | |
| SINGLE PHASE | 200-240 | 1-2, 5-6, 13-14 | 200/240V | 208V | 100/120V | 100/120V |
| | 208V | 3-4, 7-8, 13-14 | 240V | 208V | 120V | 120V |
| TWO PHASE | 400V | 3-4, 11-12 | 220-240V | -- | -- | -- |
| | 480V | 1-2, 9-10 | 240V | 208V | 120V | 120V |

THIS DRAWING AND SPECIFICATIONS HEREIN ARE THE PROPERTY OF AMERICAN POWER CONVERSION AND SHALL NOT BE COPIED, REPRODUCED OR USED IN WHOLE OR IN PART, AS THE BASIS FOR THE MANUFACTURE OR SALE OF ITEMS WITHOUT WRITTEN PERMISSION FROM APC. THIS DRAWING IS BASED UPON LATEST AVAILABLE INFORMATION AND IS SUBJECT TO CHANGE WITHOUT NOTICE.

APC
www.apc.com

TITLE: ISOLATION TRANSFORMER 20kVA
INPUT: 200-240V AC 2PH/400V AC 2PH
OUTPUT: 200-240V AC/120V AC
REAR VIEW DETAILS
PROJECT: SUBMITTAL DRAWINGS SHEET 3 OF 3

DWG NO: APTF20KW01-MM3
DRAWN: JAYAPRAKASH
ENGINEER: K. WHITE/B. BUNG CAYAO
APPROVED: M. TAVARES
REV. 1
FIRST ANGLE PROJECTION